

GRACO **TURBOBOOSTER STRETCH**



Type: Belt-positioning booster with removable back

Last date made: current

First made: 2019

Weight limits: 40 to 100 lbs. when used with backrest, at least 4 years old; 40 to 110 lbs. as a backless booster, at least 4 years old.

Harness: No harness. Vehicle shoulder and lap belt are required.



Backrest: Removable. Pull and hold height adjust lever, slide headrest into seat back until they snap into place (diagram 1). Insert fabric from headrest under fabric on lower backrest. U-shaped tabs on lower edge of backrest will interlock with bars on base (diagram 2). Insert fabric from base underneath fabric on lower backrest. Raise backrest once securely attached (diagram 3). To adjust headrest and backrest to one of five positions, lift adjustment lever on back of headrest. Once backrest is fully extended, lift lever to lift headrest to an additional four positions (diagram 4).

Belt path: Do not install restraint in a seating position with an active frontal air bag. **May be installed using Ford or Lincoln inflatable safety belt.** Use vehicle lap-shoulder belt to restrain child. Route both sides of lap belt and lower end of shoulder belt under armrest guides. If used with backrest, feed shoulder belt through belt guide just above child's shoulder (diagram 5). When used without back, an adjustable shoulder belt positioner strap is provided for use if needed. To use, attach strap to the slot on the bottom of the base, pass clip and strap through the loop end and pull strap up (diagram 6). With child's back flat against the vehicle seat, buckle child in and slide the clip onto the shoulder belt (diagram 7). Lengthen or shorten so clip fits right at top of shoulder.

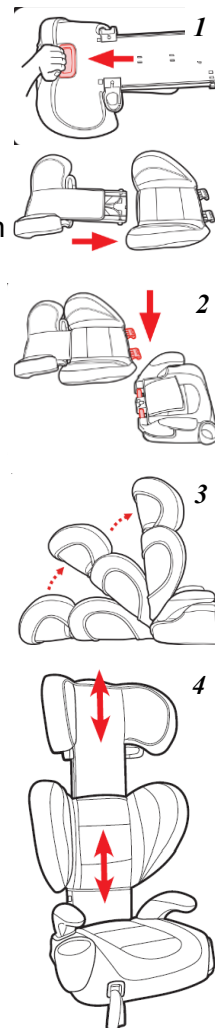

SEE PAGE 2

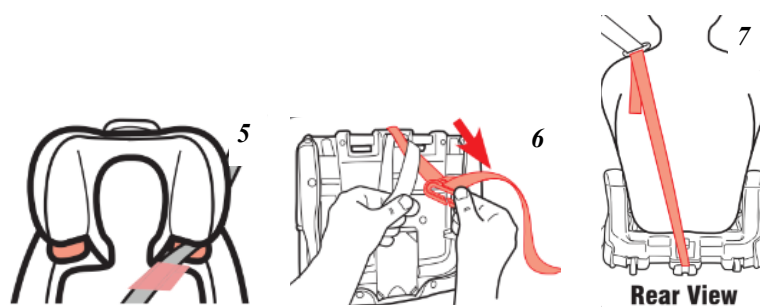

LATCH: Restraint comes equipped with lower connectors to secure restraint to vehicle. Do not use lower connectors if they interfere with any safety belts or vehicle belt buckles. Push red button on front of seat (diagram 8) and pull connectors out from back of booster (diagram 9). Attach connectors to lower anchors. Tighten by pushing restraint toward vehicle seat back and pulling straps on front of booster (diagram 10). To release lower connectors, push red button on front of seat and pull booster away from vehicle seat back.

Other: No portion of restraint bottom may extend beyond vehicle seat.

Vehicles headrest should not create a gap between vehicle seat and booster seat.

Cupholder must be installed, align tabs and push down to lock in (diagram 11).

Restraint expires ten years from date of manufacture.

There are numerous Graco models with the words "TurboBooster," in the seat name. Many have different weight limits. Check labels on restraint to confirm weight limits for that seat.

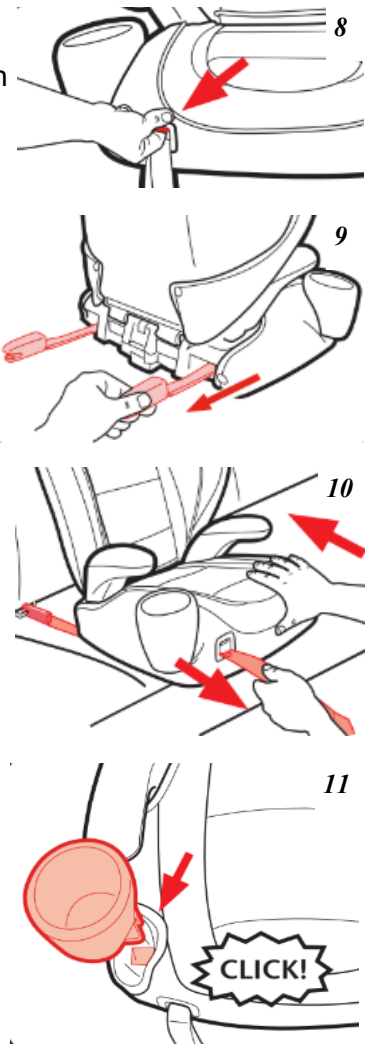

NWL0001035977A 12/19

www.gracobaby.com



TURBOBOOSTER® STRETCH

BOOSTER SEAT

Read This Instruction Manual

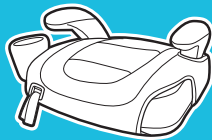

**Do not install or use
this child restraint until you read
and understand the instructions in
this manual.**

**FAILURE TO PROPERLY USE THIS
CHILD RESTRAINT INCREASES
THE RISK OF SERIOUS INJURY
OR DEATH IN A SUDDEN STOP OR
CRASH.**

1 Important

Pages 5-19

1-A Quick Guide to Your Manual

1-B Welcome to the Graco Family

1-C Before You Begin

Register This Child Restraint

If You Need Help

Certification

Car Seat's Useful Life

Vehicle Seat Protection

Warm Weather Use

1-D Safety Warnings

2 Features

Pages 20-23

2-A Car Seat Features

3 Booster

Pages 24-34

3-A Booster Use

3-B Install Booster

3-C Install Backless Booster

4 Securing Child

Pages 35-44

4-A Securing Child Backed Booster

4-B Securing Child Backless Booster

5 Accessories

Page 45

6 Vehicle Information

Pages 46-50

- 6-A How to Remove Lower Anchor Connectors**
- 6-B Choosing Vehicle Seat Location**
- 6-C Unsafe Vehicle Seat Location**
- 6-D Vehicle Seat Belts**

7 Care & Cleaning

Pages 51-55

- 7-A Cleaning Seat Pad**
- 7-B Cleaning Lower Anchor Straps**

1-A Quick Guide to Your Manual

This car seat is for children:

Booster With Back: 40-100 lb (18.1-45 kg) 43-57 in. (110.1-145 cm) at least 4 years old

Booster Without Back: 40-110 lb (18.1-50 kg) 43-57 in. (110.1-145 cm) at least 4 years old

Car Seat Assembly (On Select Models)

Adult Assembly Required

1. Attach Cup Holder

CUPHOLDER MUST BE INSTALLED.

Align locking tabs with the holes in the base. Push down to lock them in.

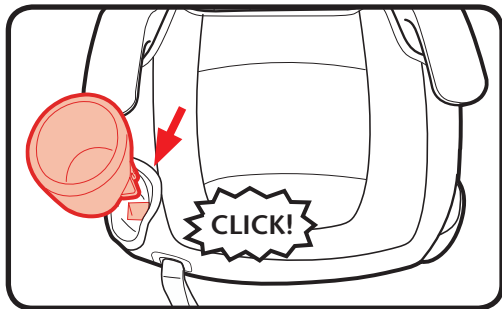

5



1 Important



1 Important

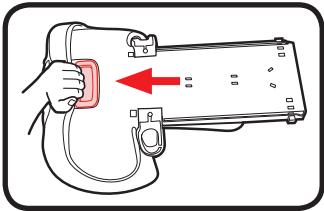

2. Pull and Hold Height Adjust Lever

Located on the back of the headrest.

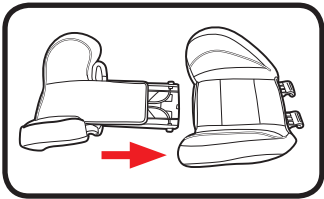

3. Attach Headrest

Slide the headrest into the seat back until they snap into place.

CHECK to make sure the two pieces are securely snapped together by pulling on them.

4. Headrest Fabric

Insert the fabric from the headrest underneath the fabric on the lower backrest as shown.

To make insertion of fabric easier, slide the upper and lower back pieces apart by pulling the adjustment lever.

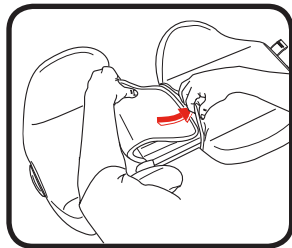

5. Attach Seat Back to Base

The “U”-shaped hooks on bottom of the seat back will interlock with bars on the base.

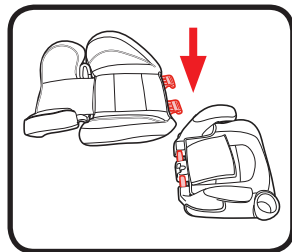
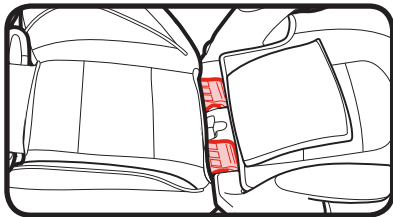

i 1 Important

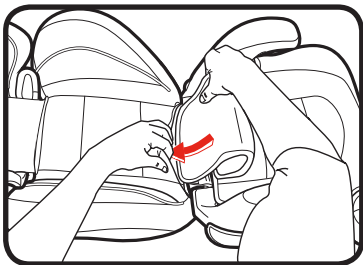

6. Base Fabric

Insert the fabric from the base underneath the fabric on the lower backrest as shown.

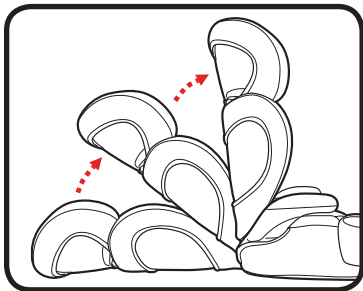

7. Raise Seat Back

Once backrest is securely attached to the base, push backrest up as shown.

Assembly Complete

Your Graco booster seat is now ready to use.

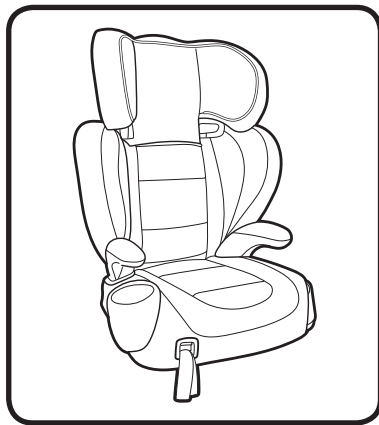

1 Important

Get to Know Your Car Seat

Review section 2-A to see all of the features of this booster seat.

What Seating Location Should I Use?

The best seating location for this booster seat is one that:

- Is recommended by your vehicle owner's manual, and
- Results in a secure installation of this booster seat.

Some vehicles have specific requirements for where the booster seat can be installed, so be sure to check your vehicle owner's manual for available seating positions, if any. For example, sometimes the center rear seat has a lap belt only vehicle seat belt, which cannot be used with this booster seat.

Review section 6-B, 6-C, 6-D of this manual AND your vehicle owner's manual.

According to accident statistics, the safest place for your child in any vehicle is the back seat. The center of the back seat can be the safest during a possible side impact.



Using The Car Seat Correctly

To make sure your child is secured properly, review section 3 and 4 to fit your child.

When Installing As a Booster

Lower Anchor System

The lower anchor system consists of lower anchor bars, which are built-in to your vehicle, and connecting hooks that are built-in your car seat.

Review section 3 of this manual AND your vehicle owner's manual.

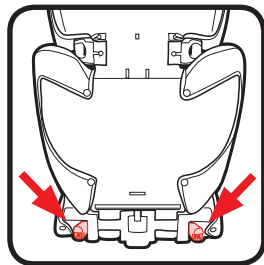

Vehicle Seat Belt

There is one type of vehicle seat belt that can be used: Lap/Shoulder Seat Belt.

Review section 3 of this manual AND your vehicle owner's manual.

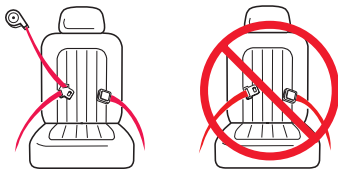

1 Important

Booster Installation

Use Lap/Shoulder Belt Only

Review section 3

Position Lap Belt

Lap belt must go in front of armrest and lie low across your child's hips and thighs.

Review section 3

Position Shoulder Belt

Shoulder belt lies across shoulder between neck and edge of shoulder.

Review section 3

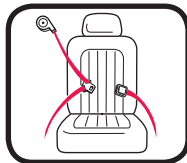

Highback



Backless

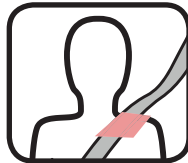

1-B Welcome to the Graco Family!

Your child's safety depends on you. No car seat can guarantee protection from injury in every situation, but proper use helps reduce the risk of serious injury or death. Even if this car seat seems easy to figure out on your own, you must follow the detailed instructions in this instruction manual to ensure the steps below are performed correctly.



1 Important



1 Important

1-C Before You Begin

Register This Child Restraint

Please fill out the prepaid registration postcard attached to the seat and mail it in today **or register online at www.gracobaby.com/carseatregistration.**

Child restraints could be recalled for safety reasons. You must register this restraint to be reached in a recall. Send your name, address, and the restraint's model number and manufacturing date to:

Graco Children's Products, Inc.

Attn: Customer Service

P.O. Box 169, Elverson, PA 19520-9901

or register online at www.gracobaby.com/carseatregistration

or call 1-800-345-4109

For recall information, call the U.S. Government's Vehicle Safety Hotline at

1-888-327-4236

(TTY: 1-800-424-9153), or go to <http://www.NHTSA.gov>.

For future reference or if you change addresses, record the model name, model number, date of manufacture and purchase date of this car seat on the below. You can find this information either on the registration card if you still have it or on the date label located on the back of the car seat.

Model Name	_____
Model Number	_____
Date of Manufacture	_____
Date of Purchase	_____



1 Important

If You Need Help

In the U.S.A, please contact our Customer Service Department with any questions you may have concerning parts, use, or maintenance. When you contact us, please have your product's model number and date of manufacture ready so that we may help you efficiently. These numbers can be found on a sticker on the back side of your car seat.

For additional resources or to get your car seat checked by a child passenger safety technician, please visit the following web sites:

www.nhtsa.gov • www.seatcheck.org • www.safekids.org

Certification

This child restraint meets or exceeds all applicable requirements of Federal motor vehicle safety standard 213 for use in motor vehicles.



This child restraint is NOT certified for use in aircraft because aircrafts do not have shoulder belts.

Car Seat's Useful Life

STOP using this car seat and throw it away 10 years after the date of manufacture. Look for date of manufacture label on back of the car seat.

Graco Children's Products Inc. advises against loaning or passing along a car seat unless you know the complete history of the product. We also advise against purchasing a car seat second hand.

Vehicle Seat Protection

Protect vehicle seat. Use a car seat mat, towel, or thin blanket under and behind car seat.

Warm Weather Use

Car seat parts can get very hot in the sun or warm weather. **To avoid burns, always check before putting child in car seat.**



1 Important

1-D Safety Warnings

No car seat can guarantee protection from injury in every situation, but proper use helps reduce the risk of serious injury or death. **READ THIS MANUAL CAREFULLY.**

! WARNING!

Failure to follow these instructions and child restraint's labels can result in child striking the vehicle's interior during a sudden stop or crash.

! When forward-facing, children should use the built-in harness system for as long as possible until they reach the maximum forward-facing weight or height for their car seat. At that point, children should ride in a belt-positioning booster seat. A booster is no longer needed once the vehicle seat belt fits properly, typically when they reach 4 feet 9 inches tall and are between ages 8-12. Be sure to check your local and state laws, as well as AAP and NHTSA recommendations, for car seat usage.

***Graco Supports the American Academy of Pediatrics and National Highway Traffic Safety Administration's Car Seat Guidelines. Visit <http://www.gracobaby.com/en-US/safety-information> for information on car seat usage recommendations.**

- ! Review your vehicle owner's manual for more information about air bags and car seat use.**
- ! If your vehicle does not have a back seat, review your vehicle owner's manual.**
- ! Select a suitable location for the car seat in your vehicle.**



1 Important

! Always secure car seat with the lower anchor hooks or a vehicle seat belt, when unoccupied. In a crash, an unsecured car seat can injure passengers.

! If car seat is in a crash, it must be replaced. DO NOT use it again! A crash can cause unseen damage and using it again could result in serious injury or death.

! DO NOT use car seat if it is damaged or missing parts.

! DO NOT use accessories or parts other than those provided by Graco. Their use could alter the performance of the car seat.

! Never leave child unattended, even when sleeping. Child may become tangled in vehicle belt straps and suffocate or strangle.



! Never attach two lower anchor connectors to one vehicle lower anchor bar unless specifically allowed by the vehicle manufacturer.

2-A Car Seat Features



2 Features

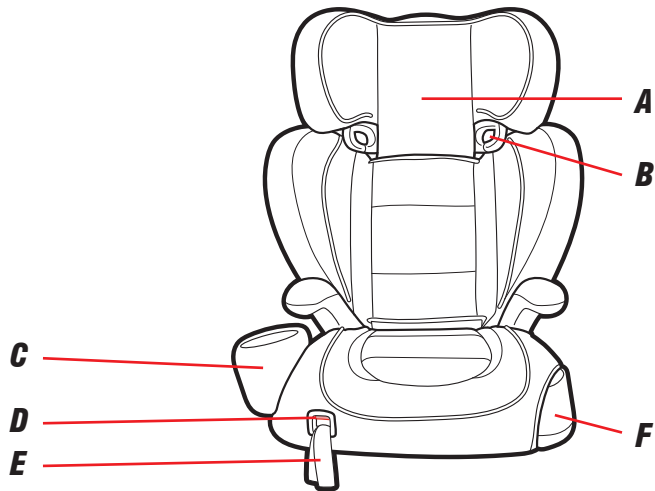

20

- A Headrest**
- B Shoulder Belt Guide**
- C Cup Holder**
- D Lower Anchor Adjuster Button**
- E Lower Anchor Adjustment Straps**
- F Storage Compartment**

2 Features

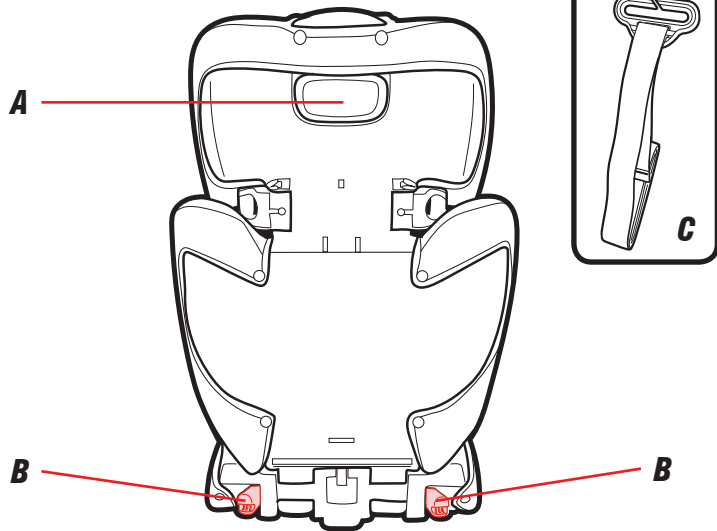

- A** *Headrest Adjustment Lever*
- B** *Lower Anchor Connectors*
- C** *Belt Positioning Clip (Inset)*

3-A Booster Use



Vehicle Lap/Shoulder Belt



Vehicle Lap/Shoulder Belt

Booster Use With Back:
40-100 lb (18.1-45 kg) 43-57 in.
(110.1-145 cm) at least 4 years old

Booster Use Without Back: 40-110 lb (18.1-50 kg) 43-57 in. (110.1-145 cm) at least 4 years old

- Place car seat forward-facing in the vehicle back seat.
- Make sure vehicle seat's lap belt is adjusted snugly and lays low on the child's hip and is routed in front of the armrest in the booster's belt path.
- Vehicle belts **MUST** lie flat against child and **MUST NOT** be twisted.
- Vehicle seat's shoulder belt is adjusted snugly and should lie between child's neck and edge of shoulder.

- **Never** use a vehicle lap-only belt across front of child.
- **DO NOT** position vehicle shoulder belt under the child's arm or back.
- **DO NOT** allow child to slouch or slide down in the booster seat.
- **DO NOT** position vehicle belt over top of armrests.
- Vehicle's seat headrest **SHOULD NOT** create a gap between vehicle seat and booster seat.
- The front of booster seat **MUST NOT** hang over front of vehicle seat.
- If child will not keep vehicle belt properly positioned, **DO NOT** use this booster seat. Use a different car seat.



Never Use a Vehicle Lap-Only Belt Across Front of Child

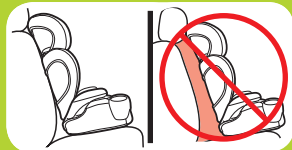



3 Booster

3-B Install Booster

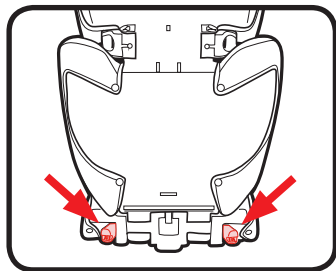

Graco allows the securing of the car seat with the lower anchor system in the booster mode. The child still **MUST BE SECURED** with the vehicle lap/shoulder seat belt. The lower anchors can be used in the booster mode regardless of the weight of the child up to 110 lb (50 kg).

Verify the following before using the lower anchors in the booster mode:

- The lower anchor attachment **DOES NOT** interfere with any vehicle seat belts or buckles.

If the lower anchor attachment interferes with the vehicle seat belts or if the chosen seating position does not have lower anchor bars, you **MUST** store the lower anchor straps. Always secure car seat with the lower anchors or a vehicle seat belt, even when unoccupied. In a crash, an unsecured car seat can injure passengers.

1. Place Car Seat Forward-Facing in Back Seat of the Vehicle

Place forward-facing in vehicle seat. The bottom of the seat should sit as flat as possible on the vehicle seat.

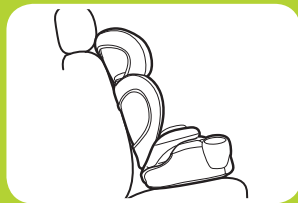

3 Booster

Skip to Step 5 if Not Using the Lower Anchors

2. Extend the Lower Anchor Straps.

For easier installation, extend the lower anchor straps to their maximum length by pressing the button on the front of the base and pulling out on the straps.

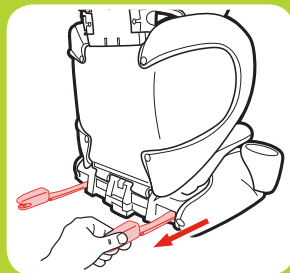
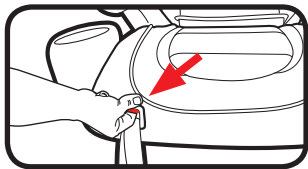



3 Booster

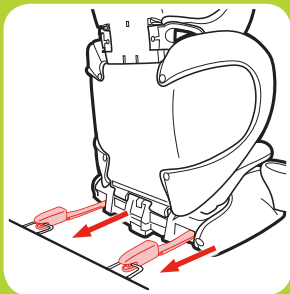

3. Attach Lower Anchor Connectors to Vehicle's Lower Anchor Bars.

Lower Anchor straps should not be twisted.

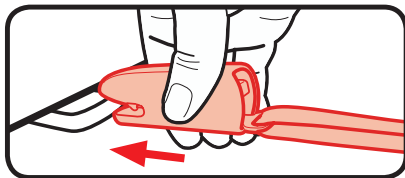

4. Tighten the Lower Anchor Straps

Remove all the slack from the lower anchor straps by pushing on the booster and pulling straps on front of the booster.

Depending on your vehicle, you may need to align the lower connectors with the slots in the base to get a good install.

The bottom of the seat should sit as flat as possible on the vehicle seat.

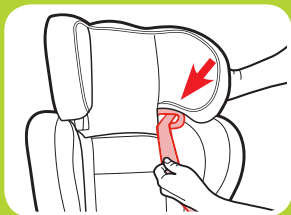
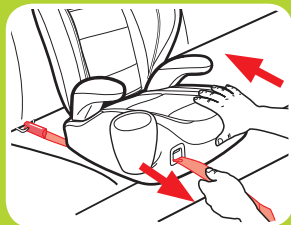
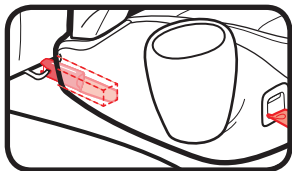

5. Thread the Vehicle Seat Shoulder Belt Through Seat Belt Guide on the Headrest

See section 4-A to secure your child.



3-C Install Backless Booster

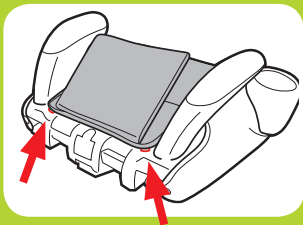
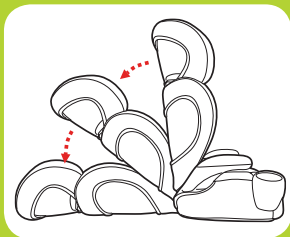

1. Remove the Backrest

Recline seat back then remove from base.

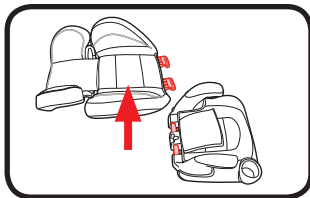

2. Undo the Two Snaps on the Top of the Base

3. Base Fabric

Tuck the fabric flap underneath the seat cover. Then reconnect the two snaps on top of the base.

4. Place the Booster Seat Forward-Facing in the Back Seat of Vehicle

Place forward-facing on a vehicle seat that has a lap/shoulder seat belt. The base should sit as flat as possible on the vehicle seat.

See section 4 to secure your child.

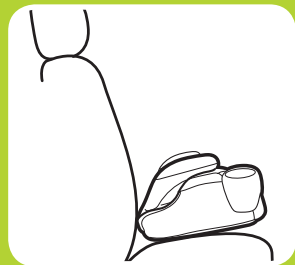
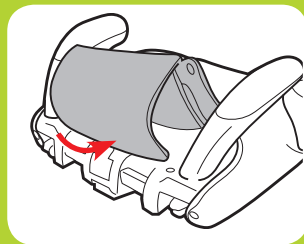



3 Booster

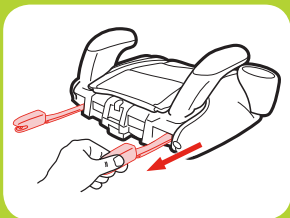

3 Booster

If Using the Lower Anchors



5. Extend the Lower Anchor Straps.

For easier installation, extend the lower anchor straps to their maximum length by pressing the button on the front of the base and pulling out on the straps.

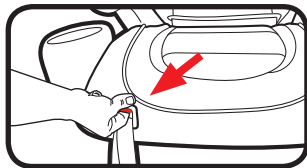

6. **Attach Lower Anchor Connectors to Vehicle's Lower Anchor Bars.**

Lower Anchor straps should not be twisted.

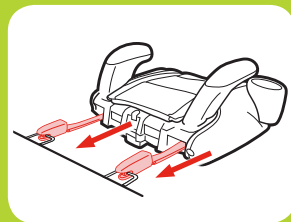
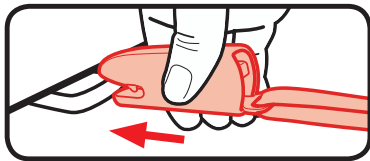

3 Booster

3 Booster 

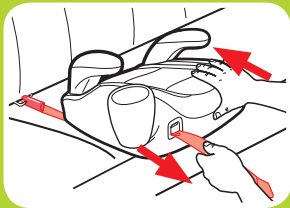

7. Tighten the Lower Anchor Straps

Remove all the slack from the lower anchor straps by pushing on the booster and pulling straps on front of the booster.

Depending on your vehicle, you may need to align the lower connectors with the slots in the base to get a good install.

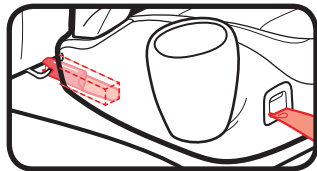

The bottom of the seat should sit as flat as possible on the vehicle seat.

4-A Securing Child Backed Booster

! WARNING!

Use only the vehicle lap and shoulder belt system when restraining the child in the booster seat.

1. Place Child In Seat

Have your child sit in the booster seat, with his/her back flat against the back of the booster seat.

2. Thread Vehicle's Shoulder Belt Into Seat Belt Guide in the Headrest

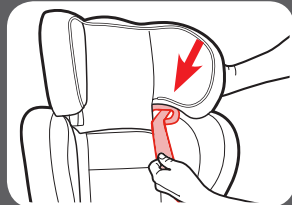

4 Securing
Child



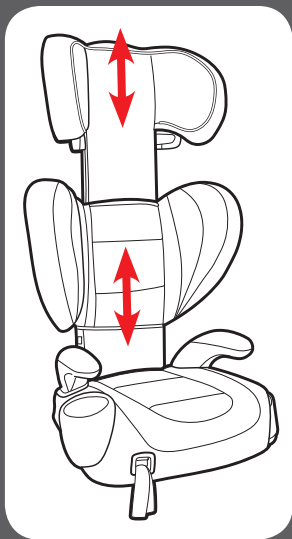

3. *To Raise or Lower Headrest*

Lift the adjustment lever and lift or lower the headrest for the proper shoulder belt height.

The TurboBooster Stretch has nine different height positions to ensure that the booster seat grows with your child.

The backrest and headrest together have five different height positions. Once at the top position, release and lift the adjustment lever again to lift the headrest into an additional four positions.

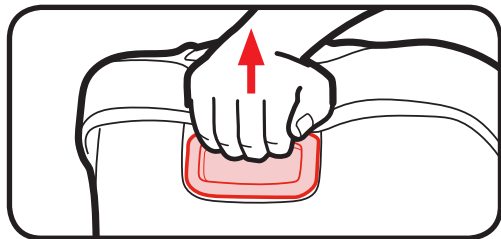

4. Buckle the Vehicle Lap/Shoulder Seat Belt

Be sure the lap portion of the vehicle seat belt goes in front of both armrests and the shoulder belt goes under the armrest on the buckle side.

Be sure the lap portion of the vehicle seat belt lies low across your child's hips.

Be sure the shoulder belt lies across your child's shoulders, between the neck and edge of shoulder by raising or lowering the headrest. The belt guides should be even with or just above the shoulders.

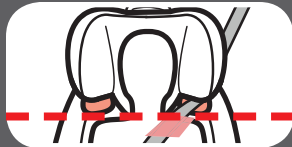

4 Securing
Child





Is Everything Correct?



Never Use Lap Belt Only



Lap Belt in Front of Armrest and Lies Low Across Hips and Thighs

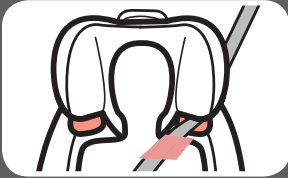

Shoulder Belt Lies On the Shoulder, Between the Neck and Edge of Shoulders

4-B Securing Child Backless Booster

! WARNING!

Use only the vehicle lap and shoulder belt system when restraining the child in the booster seat.

1. Place Child In Seat

Have your child sit in the booster seat, with his/her back flat against the back of the vehicle seat.

2. Ears Must Be Below the Top of the Vehicle Seat Back or Headrest.

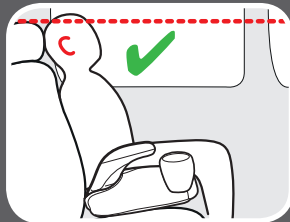

4 Securing
Child



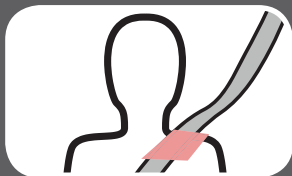
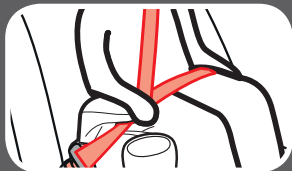

3. Buckle the Vehicle Lap/Shoulder Seat Belt

Be sure the lap portion of the vehicle seat belt goes in front of both armrests and the shoulder belt goes under the armrest on the buckle side.

Be sure the lap portion of the vehicle seat belt lies low across your child's hips.

Be sure the shoulder belt lies across your child's shoulders, between the neck and edge of shoulder.

You may need to use the belt positioning clip to help get a good fit. See "Using Belt Positioning Clip"

Is Everything Correct?

Never Use Lap Belt Only

Lap Belt in Front of Armrest and Lies Low Across Hips and Thighs

Shoulder Belt Lies On the Shoulder, Between the Neck and Edge of Shoulders

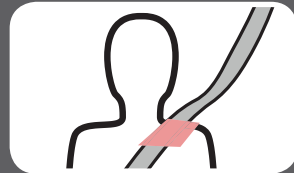
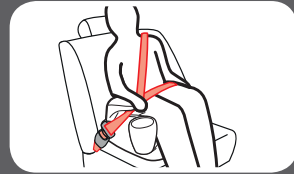

**4 Securing
Child**



Using Belt Positioning Clip

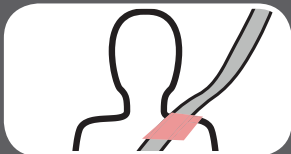

1. Make Sure Vehicle's Seat Shoulder Belt Lays in the Red Zone As Shown

If the vehicle's seat shoulder belt lays outside this zone, you **MUST** use the belt positioning clip.

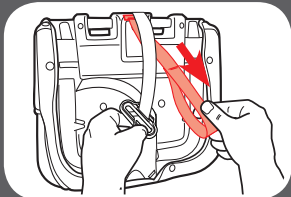

2. Attach Belt Positioning Clip

The shoulder belt positioning clip **MUST** be attached to the slot on the bottom of the base. Insert the loop end of strap through the slot on bottom of seat exactly where shown.

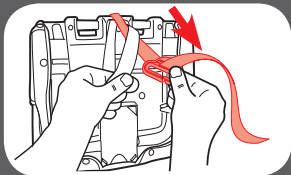
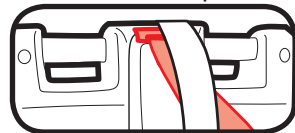

3. Push Clip and Strap Through Loop

Pass the clip and the strap through the loop end as shown and pull strap up.

4. Free End of Strap Should Face Front of Seat

5. Place Child in Seat, Buckle Child In Seat and Attach Belt Positioning Clip

With child's back flat against the back of the vehicle seat, buckle child in. Then slide the clip onto the vehicle's seat shoulder belt as shown.

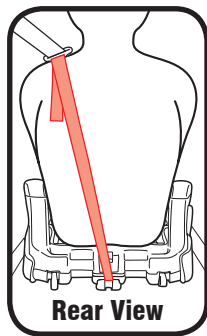

43

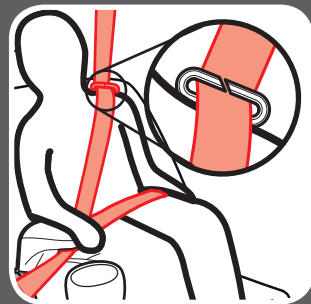
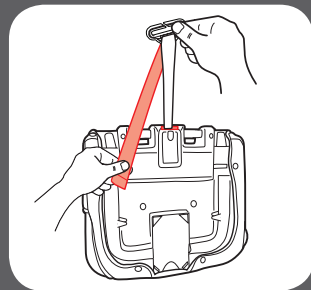

4 Securing
Child



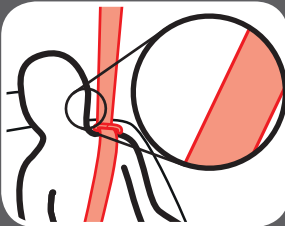
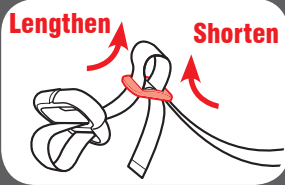

6. Adjust the *Belt Positioning Clip* to Fit Your Child

Lengthen or shorten the belt length as shown.

Clip should fit right at the top of shoulder as shown.

Be sure the lap portion of the vehicle seat belt lies low across your child's hips.

5 Accessories *(on select models)*

Cup Holder

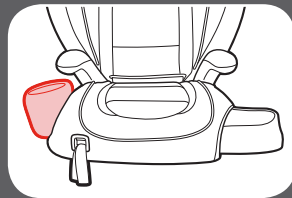

Storage Compartment

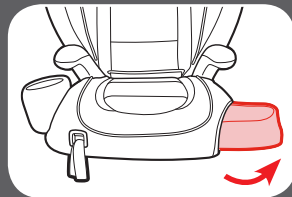



6-A How to Remove Lower Anchor Connectors

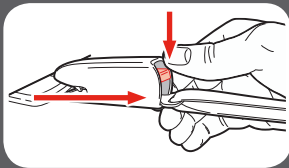
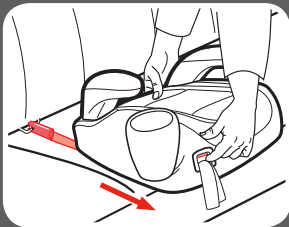

Lower Anchor Connector

Push release button up on front of booster and pull the booster slightly away from the vehicle seat.

Push down on the button and pull off.

6-B Choosing Vehicle Seat Location

Review your vehicle's owner manual for Seating Locations

The best seating location for this car seat is one that:

- Is recommended by your vehicle owner's manual, and
- Results in a secure installation of this car seat

In the event there is no available back seat and / or you have no other option, the National Highway Traffic Safety Administration (NHTSA) recommends that you take the following steps:

- Ensure the child is properly restrained according to their age and size
- Move the seat as far back as possible
- Make sure the child is not leaning out of position, such as leaning forward into the deployment path of the air bag
- Set the air bag ON-OFF switch, if available, to the OFF position





6-C Unsafe Vehicle Seat Location

Never install this car seat in any of the following vehicle seating locations:



rear-facing or side-facing
vehicle seats



booster mode with vehicle
lap belt only seat belt



6-D Vehicle Seat Belts

Review your vehicle's owner manual for vehicle seat belt use

Vehicle Seat Belt Terms

Retractor

A device that winds up the unused vehicle seat belt. It is often hidden inside the panels on the walls of the vehicle or in the vehicle seatback.

Latch Plate

The male end of the seat belt with the silver tongue.

Seat Bight

The crease where the vehicle seat back and seat bottom meet.

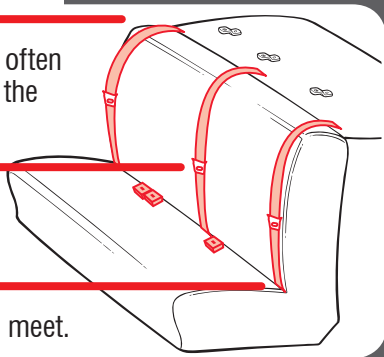



Identify Your Seat Belt Type

There is one type of vehicle seat belt that can be used with this car seat:

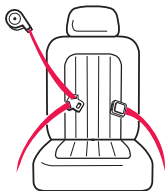

Lap/Shoulder Belt 3
connections points. Can be used
in all car seats modes of use.

The following types of vehicle seat belts **CANNOT** be used safely with this car seat:



Lap Belt Only 2
connection points.



Lap Belt with Motorized
Shoulder Belt

Belts Forward of the
Seat Bight



Lap Belt or Shoulder Belt
Mounted on Door



Some vehicles you may not
get a secure fit. Read both your
vehicle and car seat manuals.

7-A Cleaning Seat Pad

Refer to seat pad care tag for washing instructions.

Headrest Cover

Clean with a damp sponge using mild soap and cool water. If needed, headrest cover may be removed for cleaning.

To remove, raise the headrest and undo the 2 snaps.

Then undo the 2 elastic loops.

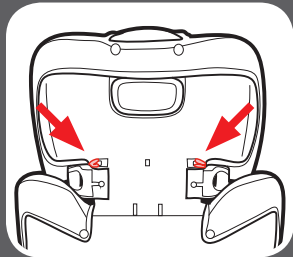
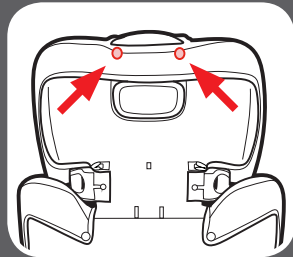

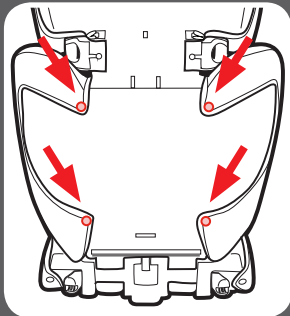
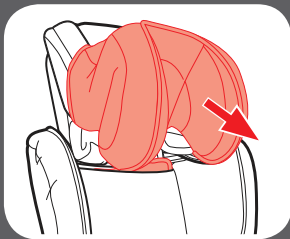

Pull off headrest cover as shown

Machine wash cover in cold water on delicate cycle and drip-dry. **DO NOT USE BLEACH.**

Reverse the steps to reattach the headrest cover.

Seat Back Cover

Clean with a damp sponge using mild soap and cool water. If needed, seat back cover may be removed for cleaning.

To remove, undo the 4 snaps on the seat back.

Pull up on seat back cover as shown.

Machine wash cover in cold water on delicate cycle and drip-dry. DO NOT USE BLEACH.

Reverse the steps to reattach the seat back cover.

Seat Bottom Cover

Clean with a damp sponge using mild soap and cool water. If needed, seat bottom cover may be removed for cleaning.

Undo the 6 snaps on the bottom of the seat.

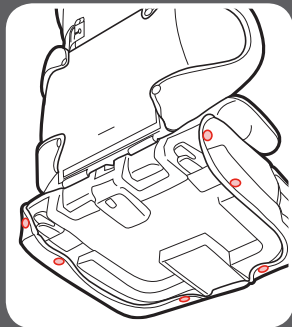
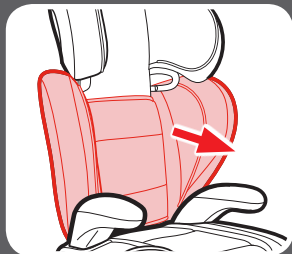

7 Care & Cleaning

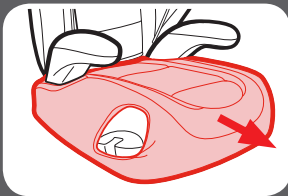
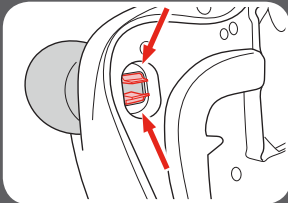
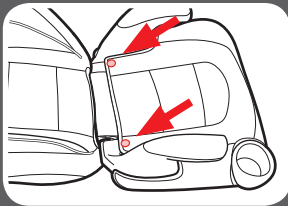

Undo the two snaps on the top of the base.

From the bottom of the seat, remove the cup holder by pinching the 2 tabs together.

Cup holder is dishwasher safe (top rack only).

Remove seat cover bottom as shown.

Machine wash cover in cold water on delicate cycle and drip-dry. **DO NOT USE BLEACH.**

Reverse the steps to reattach the seat bottom cover.

7-B Cleaning Lower Anchor Straps

Surface wash only with mild soap and damp cloth. **DO NOT IMMERSE THE LOWER ANCHOR STRAPS IN WATER** Doing so may weaken the straps.

If lower anchor straps are frayed or heavily soiled, contact Customer Service at www.gracobaby.com or 1-800-345-4109.

Replacement Parts

To purchase parts or accessories in the United States,
please contact us at the following:

www.gracobaby.com

or

1-800-345-4109



Store instruction manual in
the slot with the instruction
book icon as shown.

