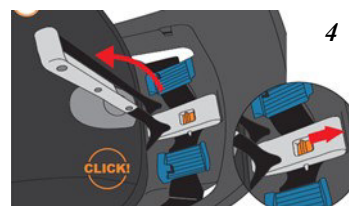
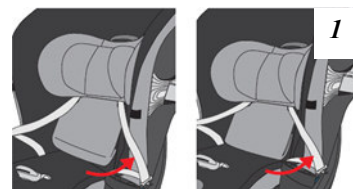

GOODBABY

CYBEX SIRONA S**Type:** Convertible**Last date made:** Current**First made:** 2020**Weight limits:** 4 to 50 lbs. rear-facing, 22 to 65 lbs. forward-facing; forward facing not recommended for child under two.**Harness:** 5-point harness**Harness:** Pull adjuster strap in front of seat to tighten harness.

Press central front adjuster at lower front of seat and pull on harness at shoulder level to loosen.

Harness slots: There is one set of slots, which may be raised or lowered by squeezing handle behind top of headrest and sliding into one of twelve locked positions. If using lower headrest/harness positions, tuck the excess headrest flap up behind the headrest pad. Two fold lines on flap allow for partial or full storage (diagram 1).**Crotch strap:** There are three positions. To change position peel back seat cover, slide buckle through padding then turn buckle webbing sideways sliding it to desired position. Position buckle in slot closest to, but not under child.**Angle adjustment:** Pull handle of recline adjuster under front of restraint. Ball must be entirely in blue area for rear facing or entirely in red area for forward facing (diagram 2). Towel roll is allowed to achieve correct angle. This child restraint is allowed to touch the vehicle seat in front of it as long as the recline angle of the child restraint is not affected.**Belt path:****Do not install restraint using inflatable safety belt.****Rear-facing and forward-facing:** Rotate restraint rear facing and move past most upright position to access belt path (refer to Other section on pg. 2 on how to rotate restraint). Remove belt path cover (diagram 3). Pull EasyLock out and up until you hear a CLICK. Slide lock button and pull up to open belt tensioner (diagram 4). Route belt(s) up through belt path on side of base, under tabs on belt guide, under belt tensioner, under tabs on opposite Belt Guide, and through opposite belt path opening then buckle (diagram 5). Close belt tensioner then push down EasyLock. 'Click' Belt Path Cover back on. **Lock vehicle belt.** Belt tensioner is NOT a lock off. Locking clip available from Cybex if needed for older vehicle.

SEE PAGE 2

Belt path: (cont.)

LATCH: When LATCH is not in use, store LATCH connectors on hooks in compartment on backside of base (diagram 6). Discontinue use of lower anchors when child is 30 lbs. rear facing and 35 lbs. forward facing.

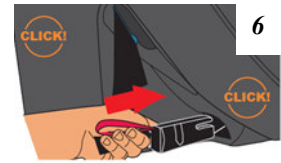

Forward facing and rear-facing: Remove connectors from storage location by pulling red latch strap release strap and rotate restraint rear facing by pulling the Recline Adjuster and moving past most upright position to access belt path. Fully extend LATCH strap. Remove belt path cover (diagram 3, pg. 1). Pull EasyLock out and up until you hear a CLICK. Slide lock button and pull up to open belt tensioner (diagram 4, pg. 1). Route LATCH strap up through belt path on side of base, under tabs on Belt Guide, under Belt Tensioner, under tabs on opposite Belt Guide, and through opposite belt path opening (diagram 5, pg. 1) then connect to lower anchors. Snug strap, close belt tensioner, push down EasyLock then put belt path cover back on. Lower anchors may be used in center seating position when position is designated as a LATCH location in vehicle owner's manual and when distance between bars is between 11 and 20 inches. **Vehicle seat headrest** that the child faces when sitting in rear-facing mode should be placed in lowest position.

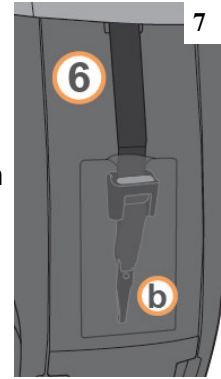

Tether: When not in use, attach Tether to the storage clip and store strap in Storage Compartment. behind seat (diagram 7).

Other: Chest clip features Sensor Safe technology.

Use of newborn insert and newborn head pad is optional. Position headrest flap behind newborn insert flap. To install newborn head pad, tuck tabs towards center into the slots on headrest cover.

Harness covers are optional.

Restraint is equipped with Linear Side-Impact Protection (LSP). Use LSP only in outboard seating positions and extend device adjacent to vehicle door. Press button to move from storage to extended. To retract LSP, push the locking arm in then push the LSP in to store (diagram 8).

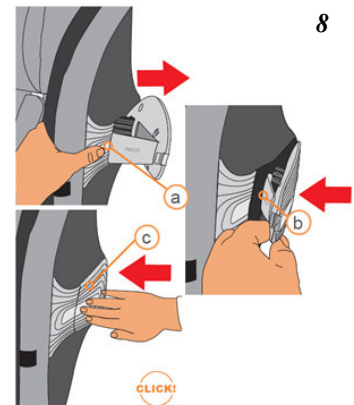

Rotate the Restraint to load/ unload child and to install in vehicle. To access belt path, pull recline handle and move restraint past most upright position (diagram 9). Rotation lock indicator will display UNLOCKED (diagram 10). Rotate seat to desired position. If in seat, child must be harnessed when rotating. Before travel ensure seat is in a locked recline position (diagram 11).

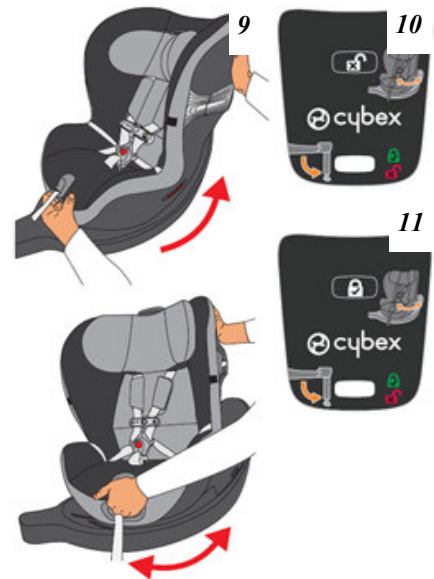

SEE PAGE 3

Other: (cont.)

To use load leg, turn base over and pull load leg out from storage compartment until it clicks. The load leg indicator will turn green when leg is fully opened and locked in position. Squeeze adjustment button to extend and retract leg. Pull down on the load leg to extend foot, then use first hole that locks it against vehicle floor. Do not use load leg for child over 40 lbs. riding forward-facing or when installing restraint using lap belt only and without tether. Store load leg under base (diagram 12) and ensure overhang indicator does not extend beyond the edge of the vehicle seat (diagram 13). Load leg must not lift base of child restraint off of vehicle seat (diagram 14).

Restraint expires 10 years from date of manufacture.

This restraint is not certified for aircraft use.

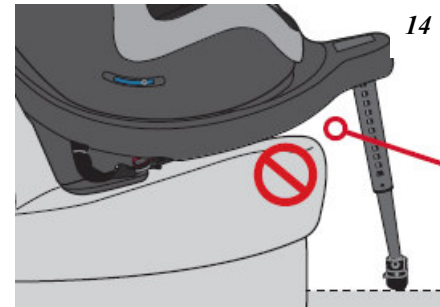
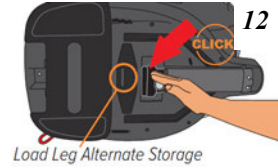

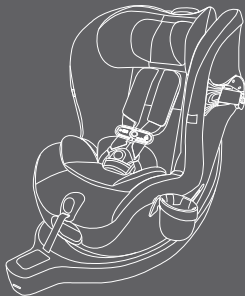

SIRONA S

Owner's Manual - Keep for future use.

Manual del propietario – Guarde para uso futuro.

▲ WARNING: To reduce the risk of death or serious injury, read this owner's manual prior to installing and using this child restraint.

▲ ADVERTENCIA: Para reducir el riesgo de muerte o lesiones graves, lea este manual del propietario antes de instalar y usar este sistema de sujeción infantil.

WELCOME TO CYBEX!

Welcome to the CYBEX family.

Thank you for purchasing the CYBEX SIRONA S. We are proud to bring this German-engineered product to the United States and Canada. We hope the SIRONA S will make your child's travel both safer and more pleasant, as well as make installation and use for you as simple as possible.

The SIRONA S brings a few important safety innovations to the convertible car seat category.

Load Leg

The adjustable Load Leg helps minimize crash forces on your child in a frontal crash. It allows the child restraint's safety systems to absorb and transfer crash forces more effectively by directing some of them to the vehicle floor. The Load Leg can be used both **REAR-FACING** and **FORWARD-FACING!**

CYBEX Rotating Base

The Rotating Base makes it easy to safely load and unload your child. When you are done, you can easily move to **REAR-FACING** or **FORWARD-FACING** mode and choose a recline position without ever reinstalling the car seat!

CYBEX Linear Side-Impact Protection (L.S.P.) System

The L.S.P. System allows the forces from a side impact collision to be reduced gradually to help minimize injuries. An adjustable headrest, deep side wings lined with thick energy absorbing EPP foam, and an adjustable side-impact device create the CYBEX L.S.P. system. This system has been optimized to protect and reduce forces on your child in the event of certain side impact crashes.

WELCOME TO CYBEX!

Please read and follow these instructions carefully to install the SIRONA S correctly, even if the installation and use of this Child Restraint might seem simple and intuitive.

Before the first use of the SIRONA S Child Restraint, please make sure you have followed all the steps in the Safety Checklist on page 119.

Following the American Academy of Pediatrics' recommendations for safe transportation of children,

REAR-FACING

Visit www.aap.org for more information on the Academy's recommendation.

No car seat can guarantee protection from injury in every situation, but proper use helps reduce the risk of death or serious injury. If you have any questions or need assistance, please contact CYBEX at 1-877-242-5676.

Also, please remember to register your Child Restraint so we can contact you in the unlikely event of a recall. Register online at: <http://register.cybex-online.com/us/carseats>

Keep this Owner's Manual for future reference by storing it in the compartment on the back of the SIRONA S Child Restraint. We appreciate your purchase and invite you to visit www.cybex-online.com to see other great CYBEX products.

**READ OWNER'S MANUAL PRIOR TO INSTALLING AND USING THIS CHILD RESTRAINT.
KEEP INSTRUCTIONS FOR FUTURE USE.**

TABLE OF CONTENTS

REGISTRATION AND RECALL INFORMATION	6
CHILD USAGE GUIDELINES.....	8
OVERVIEW OF THE SIRONA S CHILD RESTRAINT	12
WARNINGS	16
CHILD RESTRAINT FEATURES.....	34
LOWER ANCHORS AND TETHERS FOR CHILDREN (LATCH)	34
ROTATING BASE.....	38
LINEAR SIDE-IMPACT PROTECTION SYSTEM (L.S.P.)	40
LOAD LEG.....	42
OVERHANG INDICATOR.....	46
ADJUSTABLE CROTCH STRAP	47
HEIGHT-ADJUSTABLE HEADREST	48
CUP HOLDER	49
NEWBORN INSERT.....	50
NEWBORN HEADPAD INSERT.....	50
TETHER STRAP.....	51
HARNESSE COVERS.....	51
SENSORSAFE® TECHNOLOGY	52

**IF THESE INSTRUCTIONS ARE NOT FOLLOWED,
THE SAFETY OF A CHILD MAY BE SEVERELY ENDANGERED.**

**READ OWNER'S MANUAL PRIOR TO INSTALLING AND USING THIS CHILD RESTRAINT.
KEEP INSTRUCTIONS FOR FUTURE USE.**

TABLE OF CONTENTS

INSTALLING AND REMOVING CHILD RESTRAINT (REAR-FACING AND FORWARD-FACING)	53
INSTALLING CHILD RESTRAINT WITH LATCH.....	53
REMOVING CHILD RESTRAINT WITH LATCH.....	63
INSTALLING CHILD RESTRAINT WITH LAP/SHOULDER BELT (PREFERRED METHOD).....	65
REMOVING CHILD RESTRAINT WITH LAP/SHOULDER BELT	76
INSTALLING CHILD RESTRAINT WITH LAP BELT	78
REMOVING CHILD RESTRAINT WITH LAP BELT	89
SECURING CHILD WITH HARNESS	91
CARE AND CLEANING	99
GENERAL INFORMATION ABOUT SENSORSAFE®	111
USING SENSORSAFE®	115
SAFETY CHECKLIST	119
RESOURCES	120
WARRANTY.....	122

**IF THESE INSTRUCTIONS ARE NOT FOLLOWED,
THE SAFETY OF A CHILD MAY BE SEVERELY ENDANGERED.**

REGISTRATION AND RECALL INFORMATION

REGISTERING YOUR CHILD RESTRAINT

Please complete the registration card that came with your child restraint and mail it in immediately or register online.

Child restraints could be recalled for safety reasons. You must register this restraint to be reached in a recall. Send your name, address, e-mail address if available, and the restraint's model number and manufacturing date to:

Columbus Trading-Partners USA Inc.

Attn: ParentLink

1801 Commerce Drive

Piqua, Ohio 45356, USA

or call 1-877-242-5676 or register online at

<http://register.cybex-online.com/us/carseats>

For recall information, call the U.S. Government's Vehicle Safety Hotline at: 1-888-327-4236 (TTY: 1-800-424-9153), or go to www.NHTSA.gov.

REGISTRATION AND RECALL INFORMATION

CERTIFICATION

Regulatory Notice: This child restraint system meets all applicable requirements of Federal Motor Vehicle Safety Standard (FMVSS) 213.

This restraint is certified for use only in passenger and multi-purpose passenger motor vehicles, buses, and trucks equipped with lap/shoulder belt systems.

THIS RESTRAINT IS NOT CERTIFIED FOR AIRCRAFT USE.



CHILD USAGE GUIDELINES

REAR-FACING MODE

REAR-FACING use of this child restraint is **ONLY** for children who meet **ALL** of the requirements shown here. If the child is not within these requirements because they are too small, select a different child seat (such as a rear-facing only infant car seat).

If the child is **NOT** within these requirements because the child is too large, review the **FORWARD-FACING** guidelines to determine if this Child Restraint may be used.

REAR-FACING USE:

YOUR CHILD **MUST** MEET ALL THE REQUIREMENTS LISTED:

- **WEIGHT:** 1.8 - 22.6 KG (4 - 50 LBS)
- **HEIGHT:** 43.2 - 124.5 CM (17 - 49 IN)
- **CHILD'S HEAD MUST** BE 2.5 CM (1 IN) OR MORE BELOW THE TOP OF THE HEADREST OR SHELL, WHICHEVER IS HIGHER.
- Harness straps must be adjusted to be **AT or JUST BELOW** child's shoulders.

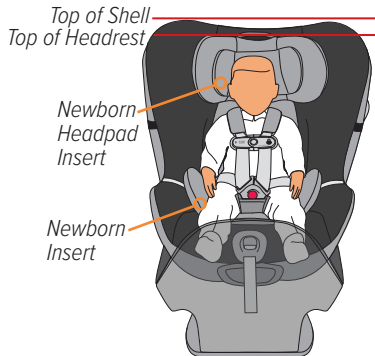
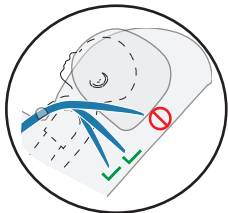

OPTIONAL USE: To ensure a better fit for smaller infants, the Newborn Insert and/or Newborn Headpad Insert may be needed (see pg. 50).

REAR-FACING MODE

When used **REAR-FACING**, make sure the Recline Ball is in the **BLUE** range as shown.

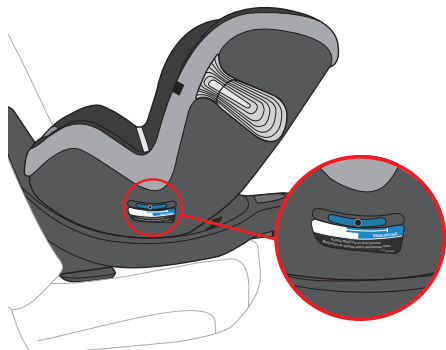

DO NOT use **LATCH** in **REAR-FACING** mode if child weighs more than 13.6 kg (30 lbs).

REAR-FACING		
1.8 kg (4 lbs)	13.6 kg (30 lbs)	22.6 kg (50 lbs)
		NO LATCH

CHILD USAGE GUIDELINES

FORWARD-FACING MODE

The American Academy of Pediatrics recommends children should ride **REAR-FACING** for as long as possible until they reach maximum height and weight for their seat.

FORWARD-FACING use of this child restraint is **ONLY** for children who meet **ALL** of the requirements shown here. If the child is not within these requirements because they are too large, select a different child seat (such as a booster seat).

If the child is **NOT** within these requirements because the child is too small, review the **REAR-FACING** guidelines to determine if this Child Restraint may be used.

FORWARD-FACING USE:

YOUR CHILD **MUST** MEET ALL THE REQUIREMENTS LISTED:

- **WEIGHT:** 10 - 29.4 KG (22 - 65 LBS)
- **HEIGHT:** 71.1 - 124.5 CM (28 - 49 IN)
- Top of ears below the top of the Headrest.
- **AGE:** at least 1 year old
- Harness straps must be adjusted to be **AT or JUST ABOVE** child's shoulders.

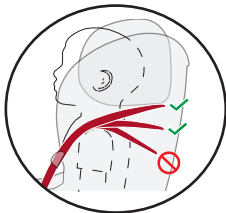

FORWARD-FACING MODE

When used **FORWARD-FACING**, make sure the Recline Ball is in the **RED** range as shown.

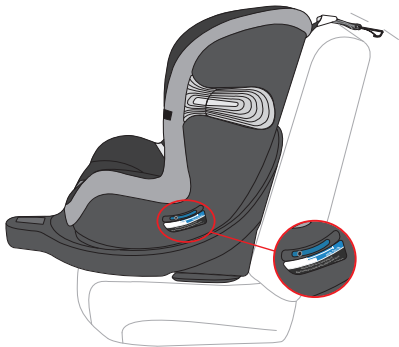

DO NOT use **LATCH** in **FORWARD-FACING** mode if child weighs more than 15.9 kg (35 lbs).

FORWARD-FACING		
10 kg (22 lbs)	15.9 kg (35 lbs)	29.4 kg (65 lbs)
		NO LATCH

OVERVIEW OF THE SIRONA S CHILD RESTRAINT

FRONT VIEW

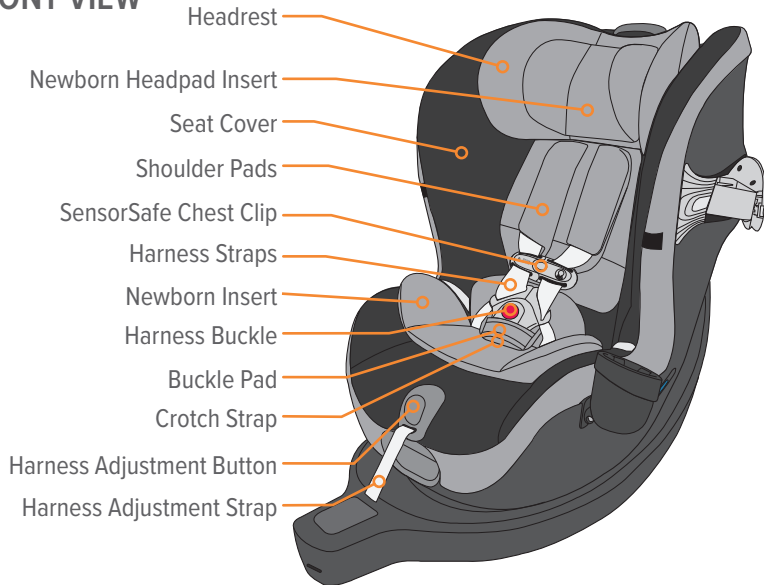

OVERVIEW OF THE SIRONA S CHILD RESTRAINT

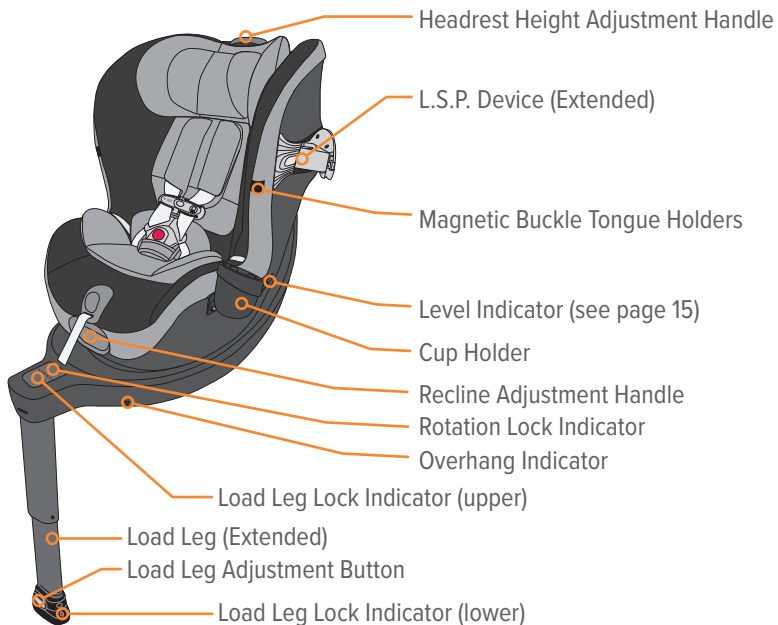

OVERVIEW OF THE SIRONA S CHILD RESTRAINT

REAR VIEW

Owner's Manual
(Inside
Compartment)

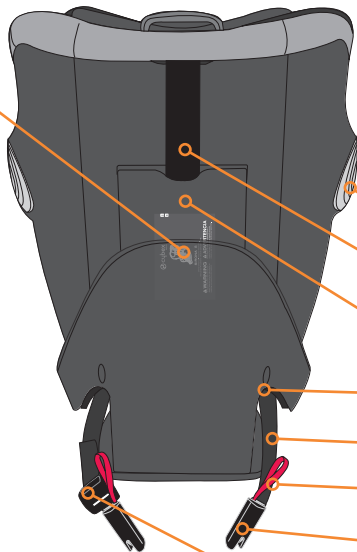

L.S.P. Device (Stored)

Tether Strap (Stored)

Tether Storage Compartment

Belt Path & Belt Tensioner
(see pg. 15)

LATCH Strap

LATCH Strap Release
Loop

LATCH Connector

LATCH Adjuster

BELT PATH & BELT TENSIONER

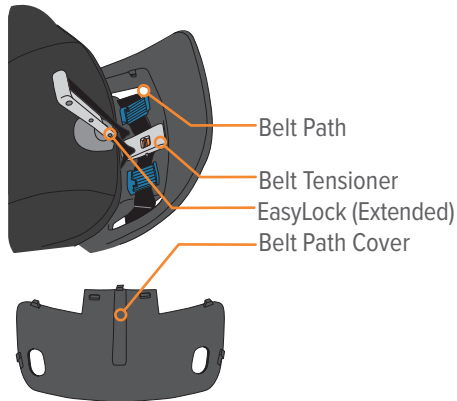

LEVEL INDICATOR

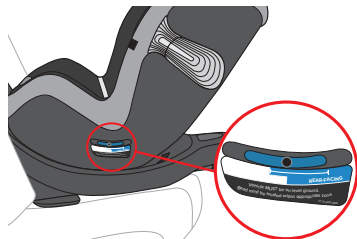

TETHER STRAP (SHOWN UNSTORED)

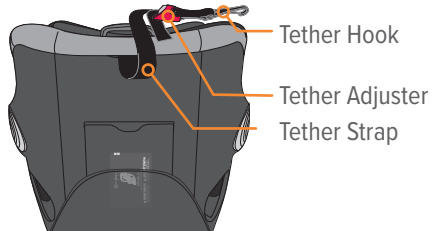

⚠ WARNING! DEATH or SERIOUS INJURY can occur

AIRBAG WARNING

⚠ WARNING ⚠ MISE EN GARDE ⚠ ADVERTENCIA



DO NOT place rear-facing child seat on front seat with air bag. DEATH OR SERIOUS INJURY can occur. The back seat is the safest place for children 12 and under.

NE PAS placer cet ensemble de retenue pour bébé conçu pour une installation face vers l'arrière sur un siège avant muni d'un coussin gonflable. Pour prévenir les BLESSURES GRAVES ou MORTELLES : Le siège arrière représente l'endroit le plus sûr pour les enfants de 12 ans et moins.

NO coloque un asiento del niño orientado hacia atrás en un asiento delantero que tenga bolsa de aire ya que podría causar la MUERTE O LESIONES GRAVES. El asiento trasero es el lugar más seguro para niños menores de 12 años.

- **DO NOT** use this restraint in the front seat of a vehicle equipped with an air bag. Interaction between a rear facing restraint and air bags may cause death or serious injury. If your vehicle has an air bag, refer to the vehicle owner's manual for child restraint installation.

⚠ WARNING! DEATH or SERIOUS INJURY can occur

- If the rear seat of your vehicle is equipped with side air bags, refer to the following information for proper usage.
- **Vehicles built prior to the 2002 model year:**
DO NOT use this restraint in a vehicle seating position equipped with a side air bag unless authorized by the vehicle manufacturer.
- **Model year 2002 and newer vehicles:**
Refer to your vehicle owner's manual before placing this restraint in a seating position equipped with a side air bag.
- **DO NOT** place any objects between the restraint and the side air bag, as an expanding air bag may cause the items to strike your child.

TIP *The SensorSafe mobile app (see page 52) can provide information, images, and/or installation videos.*

WARNING! DEATH or SERIOUS INJURY can occur

GENERAL WARNINGS

The primary protection for occupants of a vehicle in a collision is the structure of the vehicle itself. Correctly used per the instruction and labeling, this child restraint will substantially improve the chances for survival in most crashes.

- **READ** this Owner's Manual carefully before first use and keep it for future reference.
- **FOLLOW ALL INSTRUCTIONS** on this child restraint and in the written instructions stored in the compartment on the back of the child restraint.
- **NEVER** install or use this child restraint until you have read and understand the instructions in this manual, your vehicle Owner's Manual, and the labels on your child restraint. If there is a conflict between this manual and the vehicle Owner's Manual, the vehicle Owner's Manual must be followed. Failure to follow these instructions can result in death or serious injury to your child in a crash.
- **DO NOT** allow others to install or use this child restraint unless they understand how to correctly install and use it.
- **DO NOT** use a used child restraint with an unknown history.
- **NEVER USE CHILD RESTRAINT IF IT HAS DAMAGED, BROKEN OR MISSING PARTS.**

⚠ WARNING! DEATH or SERIOUS INJURY can occur

GENERAL WARNINGS

- **ALWAYS REPLACE THE CHILD RESTRAINT AFTER A CRASH OF ANY KIND, EVEN IF IT WAS UNOCCUPIED.** A crash can cause unseen damage to the child restraint that may not be visible.
- **NEVER** allow someone else to use this child restraint without also passing along this manual to them.
- **ALWAYS** check buckles and other parts for hot surfaces before placing your child in the child restraint. A hot surface could burn your child! Cover an unoccupied child restraint with a blanket when leaving it in a vehicle exposed to sunlight.
- **NEVER** leave an empty child restraint unsecured in your vehicle. This restraint must always be secured, even when not occupied. An unsecured child restraint could injure vehicle occupants in a sudden stop or crash.
- **DO NOT** attempt to make repairs to or otherwise modify or tamper with this child restraint.
- This product contains magnets, which may present a swallowing hazard. **Seek immediate medical attention if magnet(s) are swallowed or inhaled.** Before use, consult your family doctor about the compatibility of this product with pacemakers and similar devices.

⚠ WARNING! DEATH or SERIOUS INJURY can occur

LOCATION WARNINGS

- **ACCORDING TO ACCIDENT STATISTICS**, children are safer when properly restrained in rear vehicle seating positions.
- **ONLY** place this child restraint in a vehicle seating location allowed by the vehicle manufacturer. To determine allowable seating positions, refer to your vehicle Owner's Manual for information about vehicle seat belt systems, air bags, side air bags, front passenger side air bags and child restraint installations.
- **Not every location** within a vehicle may be safe for the installation of this child restraint. In fact, some vehicles have no seating position that is safe for the installation of this child restraint. Improper placement of this child restraint within a vehicle will increase the risk of death or serious injury.
- **NEVER** use this child restraint in a vehicle seating position where it cannot be secured tightly. A loosely installed child restraint will not protect your child in a crash.
- **NEVER LEAVE** a vehicle seat back with a folding mechanism unlocked. In the event of a sudden stop, an unlocked vehicle seat back could prevent this child restraint from protecting your child.
- **ONLY** use this child restraint on vehicle seats with backs that lock into place.
- **NEVER** use this child restraint on boats, low speed vehicles (LSV), all-terrain vehicles (ATV), golf carts, or any other non-certified application.

⚠ **WARNING!** DEATH or SERIOUS INJURY can occur

LOCATION WARNINGS

- This child restraint is allowed to touch the vehicle seat in front of it as long as the recline angle of the child restraint is not affected.
- **ALWAYS** use a Linear Side-impact Protection (L.S.P.) device on the side of the child restraint immediately adjacent to a vehicle door or panel (pages 40-41).
- **NEVER** extend an L.S.P. device toward a passenger or another child restraint.
- **ONLY** use this child restraint on forward-facing vehicle seats.
- **NEVER** install this child restraint in vehicle seats that face the rear or side of the vehicle.



• **VEHICLE TYPES WHERE THE RESTRAINT SYSTEM CAN NOT BE USED:**

This child restraint is **NOT** to be used in vehicles that do not have vehicle seat belts or lower anchors (see pages 30-32).

WARNING! DEATH or SERIOUS INJURY can occur

REAR-FACING WARNINGS

- When using this restraint **REAR-FACING**, **DO NOT** loosen the vehicle seat belt to provide more leg room, as this may keep the child restraint from protecting the child.
- Fold-down armrests could pose a hazard to a **REAR-FACING** child in certain types of collisions. Consult your vehicle owner's manual before installing any **REAR-FACING** child restraint in front of a fold-down armrest.
- **NEVER** turn a child restraint **FORWARD-FACING** with a child who weighs less than 10 kg (22 lbs), is less than 71.1 cm (28 in) tall, or is less than 1 year old. Crash forces may cause death or serious injury.
- **DO NOT** use the Tether Strap when the child restraint is in the **REAR-FACING** position.
- The Headrest on the vehicle seat that the child faces when sitting in the **REAR-FACING** mode should be placed in the lowest position. The vehicle seat back that the child faces must be fully padded and free of any hard objects.
- **IMPORTANT:** Infants may have difficulty breathing when in an upright seated position. Make sure they recline enough for their head to lie back comfortably and safely. Failure to properly recline the child restraint could increase the child's risk of death or serious injury.
- **SOME CHILDREN WITH SPECIAL NEEDS**, such as preemies or those who have tested positive for positional apnea, may be at increased risk of suffering breathing or other difficulties in a child restraint. Please consult a physician to determine what type of child restraint should be used.
- **DO NOT USE** this child restraint if the top of your child's head is less than 2.5 cm (1 in) from the top of the Headrest or Shell, whichever is higher, when used **REAR-FACING**.

⚠ WARNING! DEATH or SERIOUS INJURY can occur

FORWARD-FACING WARNINGS

- **DO NOT USE** this Child Restraint **FORWARD-FACING** if your child is less than 1 year old.
- **DO NOT USE** this Child Restraint if:
 - your child weighs more than 29.4 kg (65 lbs)
 - your child is more than 124.5 cm (49 in) tall
 - the harness straps cannot be adjusted **AT** or **JUST ABOVE** the child's shoulders
 - the tops of the child's ears are above the top of the Headrest.

If any of these conditions exist, **YOUR CHILD HAS OUTGROWN THE SEAT.**

- If possible, adjust or remove the vehicle Headrest in the seat where the child restraint is to be installed, so that the back of the child restraint rests against the vehicle seat back.
- The Headrest on the vehicle seat in front of the child should be put in its lowest position. The vehicle seat back that the child faces must be fully padded and free of any hard objects.

CHILD FIT WARNINGS

- **ALWAYS** check the harness buckle to make sure it is securely latched.
- **SNUGLY ADJUST** the belts provided with this child restraint around your child.
- **ALWAYS** keep your child properly secured in the harness. A snug strap should not allow any slack. It lies in a relatively straight line without sagging. It does not press on the child's flesh or push the child's body into an unnatural position.
- **NEVER** use bulky clothing or blankets that will interfere with properly positioning or tightening the harness **23**

⚠ WARNING! DEATH or SERIOUS INJURY can occur

ADDITIONAL WARNINGS

- **REGISTER** your child restraint with the manufacturer. This is the best way to reach you in the event of a recall.
- **NEVER** use this child restraint when it is older than ten (10) years. The date of manufacture can be found on a label affixed to the bottom of the child restraint.
- **WHEN NOT IN USE**, securely store the **LATCH** Connectors.
- **NEVER** use this child restraint if any of the Harness or **LATCH** straps are cut, frayed, or damaged in any way.
- **NEVER** leave child unattended.
- Children have **STRANGLED** in loose or partially buckled harness straps. Fully restrain the child.
- **DO NOT** allow children to play with this child restraint.
- **DO NOT** allow children to play with vehicle seat belts. A child within reach of a seat belt may become entangled if he or she pulls the seat belt all the way out and wraps the belt around his or her head, neck, or waist.

WARNING! DEATH or SERIOUS INJURY can occur

ADDITIONAL WARNINGS

- **NEVER** use accessories or parts with this child restraint other than those approved by CYBEX. Use of accessories or parts from other manufacturers could alter the performance of the child restraint.
- **DO NOT** leave loose objects (e.g. groceries, books, bags) in a vehicle. In the event of a sudden stop, loose objects will keep moving, potentially causing serious injuries.
- **NEVER** tend to your child's needs while driving. **ALWAYS** safely stop your vehicle in order to tend to your child.
- **NEVER** take your child out of the child restraint while the vehicle is moving. Unrestrained occupants are at a greatly increased risk of death or serious injury in a car crash.
- **DO NOT** place any cups that contain hot liquids in the cup holder.
- **DO NOT** use the cup holders to store cans or hard cups. Only for use with soft cups (such as foam or paper).

⚠ WARNING! DEATH or SERIOUS INJURY can occur

SEAT BELT WARNINGS

- **ALWAYS** read your vehicle owner's manual to determine what vehicle belts and retractors are used in your vehicle. The vehicle belt **MUST** lock and **MUST NOT** loosen after the seat belt is tightened.
- **DO NOT** use this Child Restraint if it moves more than 2.5 cm (1 in) side to side or front to back at the Belt Path on the Child Restraint when pulled with moderate force. Death or serious injury can occur from poor installation. If you cannot tightly secure the Child Restraint, try again or move it to another location.

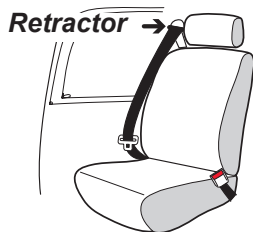

- **DO NOT** use this child restraint in a seating position with door-mounted seat belts.

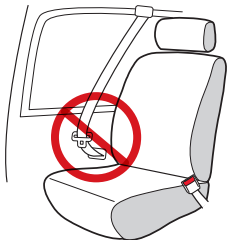

- **DO NOT** use this child restraint in a vehicle with seat belts that automatically move along the vehicle frame when the door is opened.

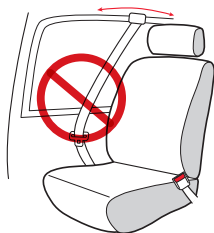

⚠ WARNING! DEATH or SERIOUS INJURY can occur

SEAT BELT WARNINGS

- **DO NOT** use this child restraint in a vehicle equipped with lap belts that only lock during a sudden stop or crash (emergency locking retractor – ELR). You must use a seating location with a locking seat belt. Check your vehicle owner’s manual to see if you have lap belts with ELRs.



- **DO NOT** use on vehicle seats when both portions of the vehicle belts are positioned forward of the seat crease.

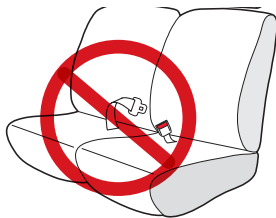

⚠ WARNING! DEATH or SERIOUS INJURY can occur

SEAT BELT WARNINGS

- **DO NOT** use with lap/shoulder belts with two retractors. If the vehicle seat belts are not routed and fastened correctly, the child restraint may not protect the child in a crash.
- **DO NOT** use with inflatable seat belts.
- Check your vehicle owner's manual to determine how to lock your seat belt for child restraint installation. The seat belt must be locked to properly secure the child restraint.
- **DO NOT** allow the vehicle seat belt release button to touch the child restraint. Accidental contact may cause the seat belt to release. If necessary, turn the seat belt release button away from the child restraint or move the child restraint to a different location.
- Failure to adjust the harness or vehicle seat belts snugly around the child may result in the child striking the vehicle's interior during a sudden stop or crash. Death or serious injury can occur.
- Child restraint systems should be securely belted to the vehicle, **even when they are not occupied**, since in a crash an unsecured child restraint system may injure other occupants.



⚠ WARNING! DEATH or SERIOUS INJURY can occur

LOCKING CLIP USE

- If your vehicle was built **prior to model year 1996**, and has a lap/shoulder belt that is equipped with an emergency locking retractor (ELR) AND sliding latch plate, you **MUST** use a Locking Clip. Check your vehicle owner's manual to identify which vehicle belt system is in your vehicle.
- If your vehicle is **model year 1996 or newer**, it likely has a vehicle belt system that can be locked when tightened, and will not require use of a Locking Clip. **Consult your vehicle owner's manual before installing a locking clip.** If your vehicle requires a Locking Clip, please call CYBEX at 1-877-242-5676 to obtain a Locking Clip and instructions on how to install and use it. Remove Locking Clip from vehicle seat belt when not used with a child restraint, or the vehicle seat belt will not properly restrain an adult or child. Death or serious injury can occur.

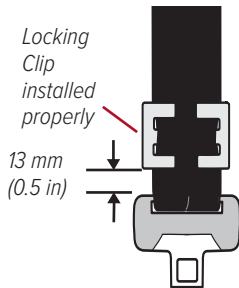

⚠ WARNING! DEATH or SERIOUS INJURY can occur

SEAT BELT WARNINGS

- If you have any of these types of vehicle belt systems listed, these are **SAFE** to use to install your child restraint in the vehicle. Review vehicle owner's manual for specific instructions on child restraint installation.

LATCH can be used IN PLACE OF these vehicle belt types. Refer to the **REAR-FACING** and **FORWARD-FACING** weight limits on **LATCH** use on pages 8-11. Refer to your vehicle owner's manual for **LATCH** locations.

Lap Belt with Locking Latch Plate

- Once buckled, the vehicle belt is tightened by pulling on the free end of the strap until the belt is tight.

Free End

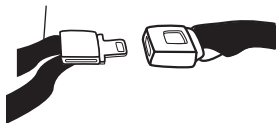

Lap Belt with Automatic Locking Retractor (ALR)

- The automatic locking retractor does not allow the lap belt to get longer once it is buckled. The vehicle belt is tightened by feeding seat belt webbing into retractor.



⚠ WARNING! DEATH or SERIOUS INJURY can occur

SEAT BELT WARNINGS

Lap/Shoulder Belt with Locking Latch Plate

- The lap portion of this belt does not loosen once the belt is buckled.
- The vehicle belt is tightened by pulling up hard on shoulder belt and feeding the extra webbing into the retractor.

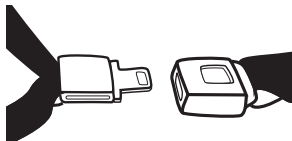

Lap/Shoulder Belt with Sliding Latch Plate with Locking Retractor

- The latch plate slides freely along the lap/shoulder belt. Vehicle belts with sliding latch plates are typically locked at the shoulder belt retractor by buckling the belt and pulling all of the webbing out slowly to switch the retractor.
- Check vehicle owner's manual for specific instructions. The vehicle belt is tightened after switching the retractor by pulling up on shoulder belt and feeding the webbing into the retractor.

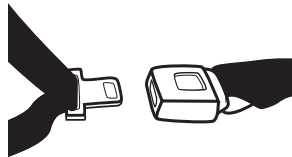



! WARNING! DEATH or SERIOUS INJURY can occur

LATCH WARNINGS

- **ONLY** use **LATCH** for securing Child Restraint to Vehicle Lower Anchor Bars.
- **DO NOT** use the lower anchors of the child restraint anchorage (**LATCH**) system to attach this child restraint when restraining a child weighing more than 13.6 kg (30 lbs) **REAR-FACING** OR 15.9 kg (35 lbs) **FORWARD-FACING**. **ONLY USE VEHICLE BELT INSTALLATION.**
- In addition to these instructions, read and follow your vehicle Owner's Manual regarding installation of the child restraint and **LATCH**. If there is a discrepancy, follow your vehicle owner's manual.
- **NEVER** attach two **LATCH** Connectors to one Vehicle Lower Anchor Bar.
- **NEVER** use the vehicle seat belts when using the lower anchor connector assembly. Using both together can cause slack in a sudden stop or crash.
- To avoid strangulation, you must store excess **LATCH** Straps in the vehicle seat crease as described on page 37.
- **ALWAYS** be sure that the **LATCH** Connectors are attached to the Vehicle Lower Anchor Bars by pulling hard on the connectors. If they are not attached, the **LATCH** Connector assembly will not secure your Child Restraint. **DEATH OR SERIOUS INJURY CAN OCCUR.**
- **DO NOT** use this Child Restraint if it moves more than 2.5 cm (1 in) side to side or front to back at the Belt Path on the Child Restraint when pulled with moderate force. Death or serious injury can occur from poor installation. If you cannot tightly secure the Child Restraint, try again or move it to another location.



! WARNING! DEATH or SERIOUS INJURY can occur

TETHER STRAP WARNINGS

- To avoid a strangulation hazard, you **MUST** store the Tether inside the Tether Storage Compartment on the back of the Child Restraint when not in use. Attach the Tether Hook to the Storage Clip when not in use. This will keep an unused Tether or Tether Hook from hitting someone during a crash.
- The Tether Strap is for **FORWARD-FACING** use **ONLY**.
- Refer to your vehicle Owner's Manual for the location of the Tether Anchor in your vehicle. Older vehicles may not come equipped with Tether Anchor hardware. Check with your vehicle dealer.

CHILD RESTRAINT FEATURES LOWER ANCHORS AND TETHERS FOR CHILDREN (LATCH)

What is LATCH?



LATCH (Lower **A**nchors and **T**ethers for **C**hildren) refers to a pair of fixed Lower Anchors (or bars) and a Top Tether Anchor that are built into your vehicle.

LATCH is standard in vehicles manufactured after

September 1, 2002. Refer to your vehicle Owner's Manual for anchor positions in your vehicle.

The **LATCH** anchors are located in the crease between the vehicle seat back and seat cushion, and if not visible, will typically be indicated by  symbols. Top Tether Anchors are located in various places behind the rear vehicle seat (see page 51).

LATCH can offer an easier and more consistent installation.

However, this child restraint can be safely installed using either

Lower Anchors or vehicle belts and meets the requirements

of FMVSS 213 with either installation method. Either method is safe for your child when installed correctly. When using either method, it is best practice to ALWAYS use Top Tether when installing

FORWARD-FACING.

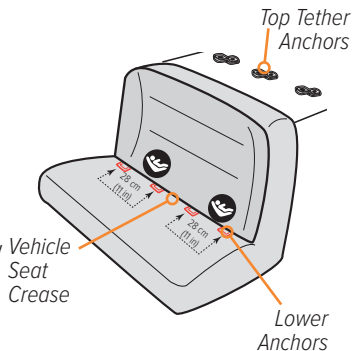

CHILD RESTRAINT FEATURES LOWER ANCHORS AND TETHERS FOR CHILDREN (LATCH)

Outer Seating Positions

Use the Lower Anchors OR a vehicle seat belt to install the Child Restraint in outboard seating positions (those on either side of the center position).

NEVER use Lower Anchors together with the vehicle belts to install this Child Restraint. Using both is not approved and may cause improper performance of the Child Restraint.

Center Seating Positions

If your vehicle does not have Lower Anchors in the center seating position, check your vehicle Owner's Manual to see if you are allowed to use the two inner Lower Anchors from the outboard seating positions to install a Child Restraint.

CYBEX allows this Child Restraint to be installed using the two inner Lower Anchors from the outboard seating positions if the distance between them is between 28-51 cm (11-20 in) AND if your vehicle manufacturer allows it. (If distance is not correct and/or not allowed by vehicle manufacturer, use the vehicle belt for installation in the center position.)

When using the inner Lower Anchors make sure there are no obstructions from a buckle stalk for the installation and that the **LATCH** Straps/Connectors do not block vehicle belt buckles.

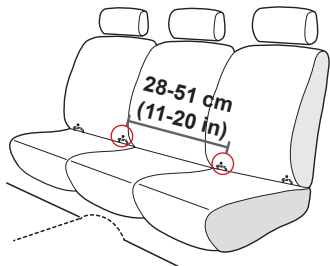

CHILD RESTRAINT FEATURES LOWER ANCHORS AND TETHERS FOR CHILDREN (LATCH)

To Remove from Storage:

1. Pull on the **LATCH** Strap Release Loop and pull the Connector out of the storage compartment. Repeat on other side.

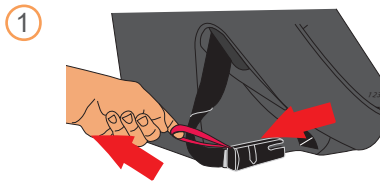

2. Lengthen the strap between the connectors using the **LATCH** Strap Adjuster located next to the connectors. Push down on the Adjuster button while lengthening strap.

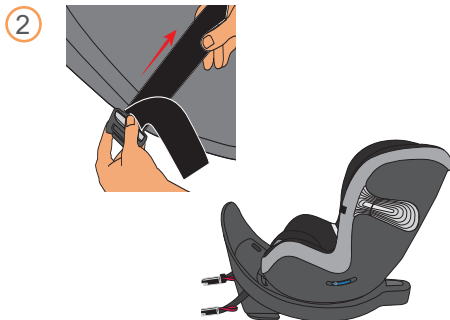

CHILD RESTRAINT FEATURES LOWER ANCHORS AND TETHERS FOR CHILDREN (LATCH)

To Store:

LATCH Connectors **MUST** be stored when not in use. Loose Connectors could seriously injure vehicle occupants in the event of a crash.

1. Fully extend the **LATCH** Strap. Slide each Connector back into its storage slot until an audible **CLICK** is heard.
2. Make sure Belt Tensioner and EasyLock are closed.
3. Remove most of the slack from the **LATCH** strap by pulling on the **LATCH** Adjuster Strap until it lays flat through the Belt Guides. **Do not overtighten** or remove more slack than necessary.
4. Tuck the excess strap into the vehicle seat crease to get it out of the way.

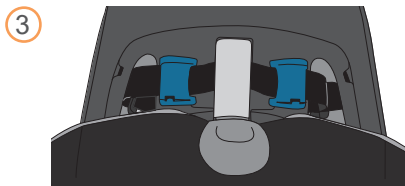
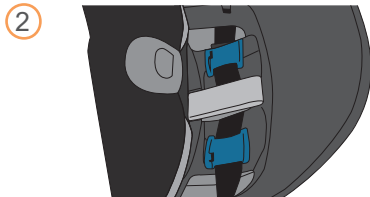
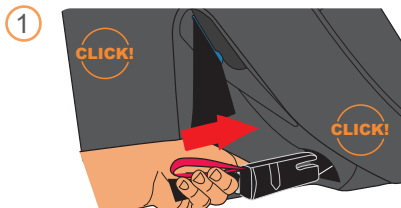

CHILD RESTRAINT FEATURES ROTATING BASE

WARNING!
DEATH or SERIOUS INJURY
can occur

NEVER use this child restraint in a vehicle seating position where it cannot be secured tightly. A loosely installed child restraint will not protect your child in a crash.

The Sirona S rotates in its base (a), making it easy to safely load and unload your child **when the seat is properly installed**. To rotate the Restraint, pull the Recline Handle and move the Restraint past the most upright position. The Rotation Lock Indicator will display the word UNLOCK (page 39).

Rotate the seat to your desired loading/unloading position. When your child is securely harnessed, rotate back to **REAR-FACING** or **FORWARD-FACING** position (b) based on your child's size (pages 8-11). Then **move back into a locked recline position**. The Rotation Lock Indicator will display the word LOCK (page 39).

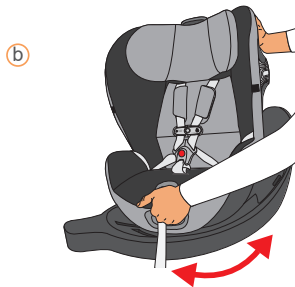
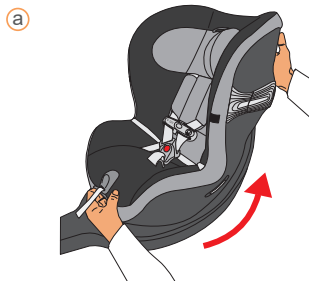

CHILD RESTRAINT FEATURES ROTATING BASE

WARNING!
DEATH or SERIOUS INJURY
can occur

THE ROTATED POSITION IS FOR LOADING AND UNLOADING YOUR CHILD ONLY!

The Sirona S is not designed to protect your child in a crash when the Rotation Lock Indicator displays the UNLOCK symbol. (a)

The Sirona S **MUST BE LOCKED** for proper use when vehicle is moving.

Make sure the Rotation Lock Indicator displays the LOCK symbol (b) and the Level Indicator is in the correct range before driving (see pages 9 and 11).

(a)

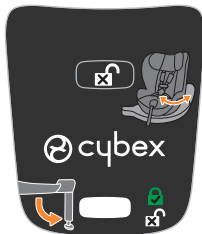

(b)



CHILD RESTRAINT FEATURES LINEAR SIDE-IMPACT PROTECTION SYSTEM (L.S.P.)

The Linear Side-Impact Protection System (L.S.P.) is built into the Sirona S. This system enhances the safety of your child in the event of certain side crashes. In order to achieve the best possible protective effect, extend the L.S.P. towards the car door closest to the child restraint.

ALWAYS USE the L.S.P. Device when the Child Restraint is installed in an outer seating position.

ALWAYS USE an L.S.P. Device on the side of the Child Restraint immediately adjacent to a vehicle door or panel.

NEVER USE the L.S.P. device when the Child Restraint is placed in the rear middle seating position.

NEVER extend an L.S.P. device toward a passenger or another Child Restraint.

NEVER lift or carry the Child Restraint using the L.S.P. devices.

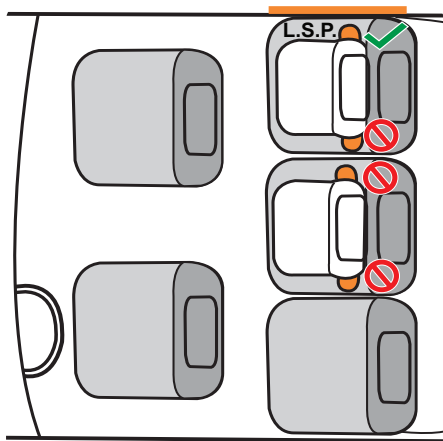

CHILD RESTRAINT FEATURES LINEAR SIDE-IMPACT PROTECTION SYSTEM (L.S.P.)

EXTENDING THE L.S.P.

Press the L.S.P. button **(a)** on the side of the Restraint adjacent to the vehicle door. The L.S.P. will extend out from the Restraint and be secured in place by the Locking Arm.

RETRACTING THE L.S.P.

Push the Locking Arm in to unlock the L.S.P. **(b)**, then push the L.S.P. into the side of the Restraint to store **(c)**.

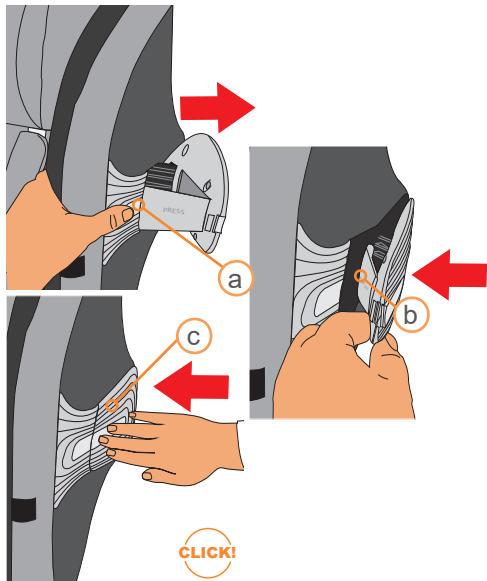

CHILD RESTRAINT FEATURES LOAD LEG

⚠ **WARNING!** DEATH or SERIOUS INJURY can occur

The Load Leg is an effective safety feature of the Sirona S. **Using it is strongly recommended.**

If **ALL INSTALLATION REQUIREMENTS** for the Load Leg **CANNOT BE MET**, you **MUST** choose another seating position or install the Restraint with the Load Leg stored (folded underneath). When installing with the Load Leg stored, see page 46 for proper use of the Overhang Indicator.

INSTALL the Restraint in a seating position that will allow the Load Leg to be extended into a **locked position** and have **firm contact with the vehicle floor** (see page 44).

Many vehicles have a hump in the floor that could cause the Load Leg, even in its shortest position, to push the Base off the vehicle seat. **NEVER INSTALL** the Restraint in a seating position where the Load Leg, even in its shortest position, causes the

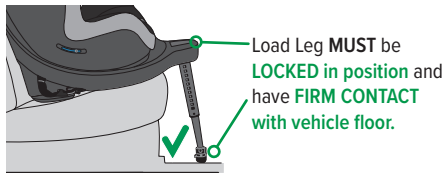

There should be a gap between the Load Leg Foot and the vehicle floor.

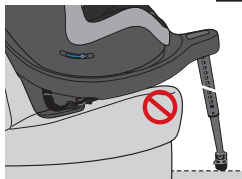
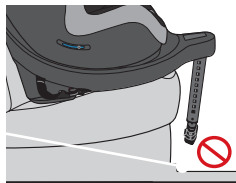

The Load Leg should not push off the vehicle seat.

CHILD RESTRAINT FEATURES LOAD LEG

To Install:

1. Turn the base over and pull the Load Leg out from the Storage Compartment.
2. Pull the Load Leg out until it **CLICKS** and is locked into the fully open position.
3. The Load Leg Indicator will turn **GREEN** when locked.

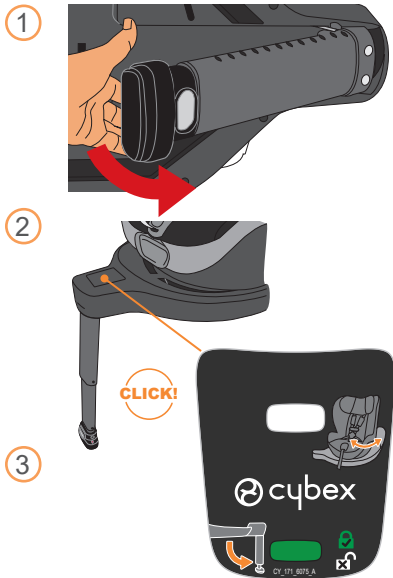

CHILD RESTRAINT FEATURES LOAD LEG

To Extend:

Pull down on the Load Leg to extend the Foot until it rests on the vehicle floor.

NOTE: If the Load Leg does not reach the floor, squeeze the Load Leg Adjustment Button on the foot and pull down to further extend.

As you lower the Load Leg, the Load Leg Lock Indicator buttons on either side of the foot will show green as long as the Leg makes firm contact with the vehicle floor.

Secure the Foot into place using the first hole that will lock it firmly against the vehicle floor without lifting the Base up off of the seat.

It may be necessary to lift up slightly on the Base to allow the Foot to lock into the hole.

To Retract:

Squeeze the Load Leg Adjustment Button and push up on the foot to retract it.

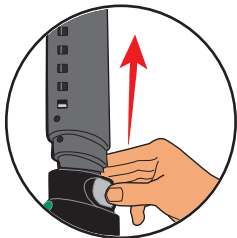
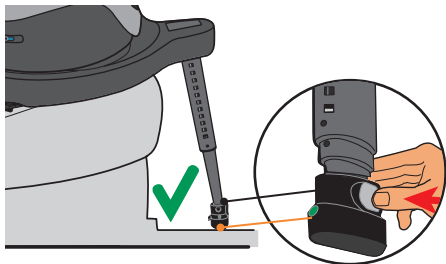

CHILD RESTRAINT FEATURES LOAD LEG

To Store:

1. Turn the Base over and rotate the Load Leg towards the Storage Compartment.

1

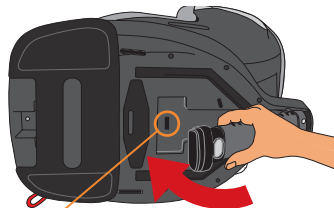

Load Leg Storage

2. Push the Load Leg in until it **CLICKS** and locks into the Storage Compartment.

2

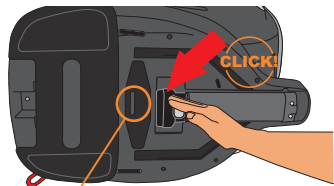

Load Leg Alternate Storage

NOTE: If your child is over 40 pounds and riding forward-facing in an older vehicle with a lap belt only and no Tether Anchor, use the alternate storage position when storing the Load Leg.

CHILD RESTRAINT FEATURES OVERHANG INDICATOR

When installing the Sirona S with the Load Leg stored, ensure the seat base is positioned on the vehicle seat so that the Overhang Indicator does not extend beyond the edge of the vehicle seat.

If the Overhang Indicator extends beyond the edge of the vehicle seat, you **MUST** choose another seating position.



CHILD RESTRAINT FEATURES ADJUSTABLE CROTCH STRAP

As your child grows, you will need to change the Crotch Strap position. The Crotch Strap should **ALWAYS** be as close to but **NEVER** underneath your child's bottom.

1. Remove Buckle Pad.
2. Unfasten snaps on seat cover behind Headrest Pad and lift cover up.
3. Pull the Seat Cover forward. Slide the Crotch Strap through the pad opening.
4. Grasp the bottom of the Crotch Strap and twist it to align with the lengthwise slot.
5. Move to slot position **closest to but not underneath** your child's bottom. Twist strap back into position.
6. Re-attach the Seat Cover and Buckle Pad.

①

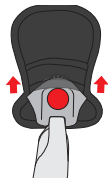

②

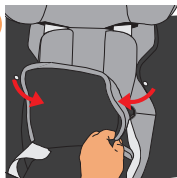

③

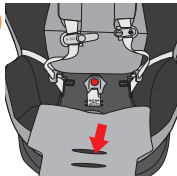

④



⑤

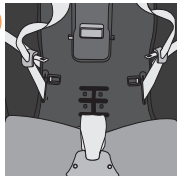

⑥



CHILD RESTRAINT FEATURES HEIGHT-ADJUSTABLE HEADREST

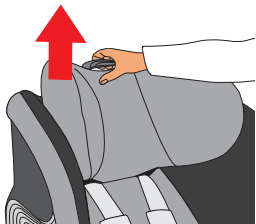

The seat has a Headrest that automatically adjusts the harness height without the need to re-thread it. To adjust, lift the Headrest Height Adjustment Handle on the top of the Headrest and move to one of the 12 locked positions.

For **REAR-FACING** use, adjust Headrest so the harness straps are **AT or JUST BELOW** the child's shoulders.

For **FORWARD-FACING** use, adjust Headrest so the harness straps are **AT or JUST ABOVE** the child's shoulders.

NOTE: Regularly check for proper harness height as your child grows.

REAR-FACING

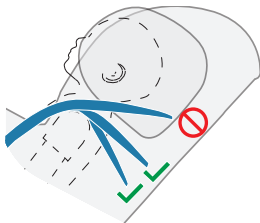

FORWARD-FACING

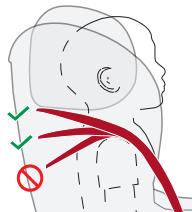

CHILD RESTRAINT FEATURES CUP HOLDER

! WARNING! DEATH or SERIOUS INJURY can occur

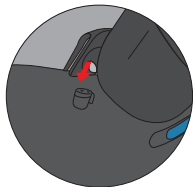
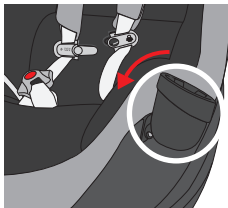

Slide the Cup Holder onto either side of the Child Restraint where indicated by the Cup Holder icon.

- **ONLY** use the cup holders that come with your original car seat or have been specifically designed for it by CYBEX.
- **DO NOT** use the cup holder to hold hot liquids (e.g. coffee), even in enclosed or lidded containers. Placing hot liquids in the cup holder could result in spills and burn injuries to you or your child.
- **NEVER** place sharp or pointed objects in the cup holder. In a crash these objects could hit you or your child and cause serious injuries.
- **ONLY** use containers that fit securely all the way to the bottom of the cup holder. They should not stop halfway down when placing containers in the cup holder.
- **ONLY** use containers with a capacity of 355 ml (12 oz.) or less.
- **NEVER** use any containers which are made of brittle material (e.g., glass). This could lead to injuries in the event of a crash.
- **NEVER** leave open containers in the cup holder during the journey. There is a risk of spilling (e.g., when braking), which may cause damage to the electrical components of the vehicle or seat upholstery.
- **ALWAYS** remove containers before removing the cup holder from the car seat.
- **ALWAYS** remove containers from the cup holder before reclining the car seat. There is a risk of spilling, which may cause damage to the electrical components of the vehicle or seat upholstery.

CHILD RESTRAINT FEATURES NEWBORN INSERT

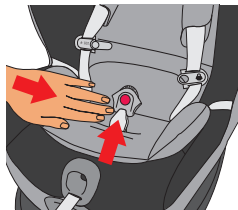

To ensure a better fit for smaller infants, the Newborn Insert may be needed. **ONLY USE** the Newborn Insert that comes with your original car seat or one that has been specifically designed for it by CYBEX.

To Install:

1. Pull Harness Buckle through slot in the bottom of Newborn Insert.
2. Pull both Harness Straps over the side panels of Newborn Insert.
3. Push Newborn Insert firmly into Child Restraint to make sure it is properly positioned.
4. When positioning the Headrest make sure the bottom of the Headrest flap is behind the Newborn Insert flap.

CHILD RESTRAINT FEATURES NEWBORN HEADPAD INSERT

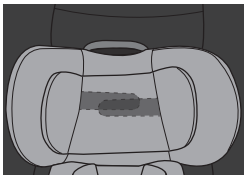

To ensure a better fit for smaller infants, the Newborn Headpad Insert may be needed. **ONLY USE** the Newborn Headpad Insert that comes with your original car seat or one that has been specifically designed for it by CYBEX.

To install, tuck the tabs on the rear of the Newborn Headpad Insert into the slots on the Headrest cover and toward the center of the Headrest.



CHILD RESTRAINT FEATURES TETHER STRAP

A Tether reduces movement of a **FORWARD-FACING** Child restraint in a crash and helps to achieve a tight installation. **ALWAYS USE A TETHER FORWARD-FACING** if a Tether Anchor is available.

Tether anchor locations vary from vehicle to vehicle and some typical locations are shown here. Refer to your vehicle Owner's Manual for exact locations, anchor identification , and requirements.

See pages 59, 73, and 86 for Tether installation and storage instructions.

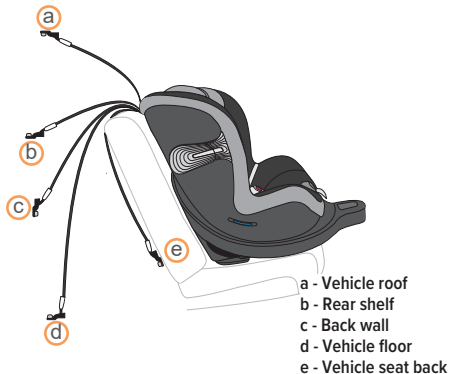

CHILD RESTRAINT FEATURES HARNESSES COVERS

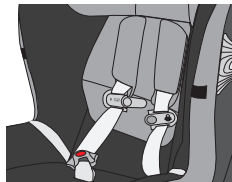

Install Harness Covers above Chest Clip. Harness Covers are optional for comfort. Wrap Harness Covers around Harness Straps and fasten the snaps.

ALWAYS make sure the harness covers **DO NOT** bunch up when tightening the harness.

⚠ WARNING! DEATH or SERIOUS INJURY can occur

NEVER install or use this child restraint until you have read and understand the instructions in this manual and in your vehicle Owner's Manual. If there is a conflict between the two, the vehicle Owner's Manual must be followed.

**This seat works with the SensorSafe mobile app which can be downloaded from:
The App Store® or Google Play™.***

The SensorSafe mobile app can provide the following information directly to your smartphone:

- Reminder that your child is still in your automobile
- Current temperature of your automobile interior
- Owners Manuals
- Installation Videos
- Customer care contact information

SensorSafe® Technology

Questions? Comments?:

Visit us at: <http://cybex-online.com/us/contact.html>

or call CYBEX at: 1-877-242-5676

* Trademarks are the property of their respective owners.



INSTALLING CHILD RESTRAINT WITH LATCH

REAR-FACING: **DO NOT** install by this method for a child weighing more than 13.6 kg (30 lbs). **ALWAYS** store Tether Strap when using **REAR-FACING**.

FORWARD-FACING: **DO NOT** install by this method for a child weighing more than 15.9 kg (35 lbs). **ALWAYS USE A TETHER FORWARD-FACING** if a Tether Anchor is available.

BEFORE installing Restraint, make sure vehicle is on level ground. Place Restraint on approved **LATCH** vehicle seating location.

1. Remove **LATCH** Anchors from storage locations on back side of base. Remove each Connector by pulling out on Red Strap.

1

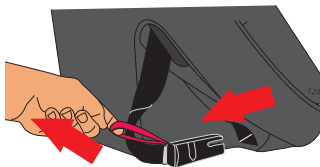

2. Unfold Load Leg from underneath Base.

2

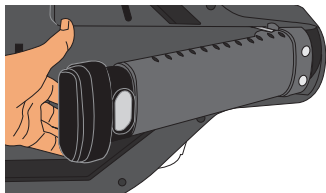



INSTALLING CHILD RESTRAINT WITH LATCH

3. Position Restraint on rear vehicle seat. If a hump is present on vehicle floor, see page 42 for important information on limits of using Load Leg in this seating position.

NOTE: If installing the Restraint with the Load Leg stored, see Overhang Indicator on page 46.

4. Rotate Restraint **REAR-FACING** and move past the most upright position to access the Belt Path (pages 38-39).

3



4





INSTALLING CHILD RESTRAINT WITH LATCH

5. Remove Belt Path Cover from Base.

5

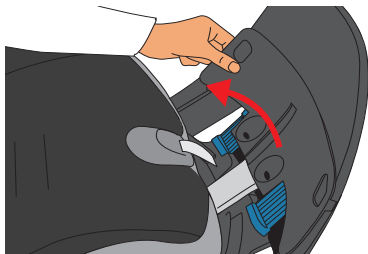

6. Open Belt Tensioner.
 - a. Pull EasyLock out and up to extend until you hear a CLICK.
 - b. Slide Lock Button and pull up to open Belt Tensioner in center of Base.

6

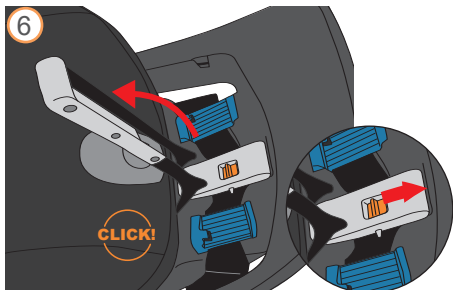

INSTALLING CHILD RESTRAINT WITH LATCH



7. Attach **LATCH** Connectors to vehicle Lower Anchor Points. Connectors will make an audible **CLICK** when attached. Make sure they are attached by pulling firmly on connectors. **Do not pull on red Release Strap.**

7



8. Push Base against vehicle seat back. Tension **LATCH** Strap by pulling on loop until snug. **Do not overtighten.** Belt Tensioner will tighten system fully. After tightening **LATCH**, route excess strap across belt path.

8

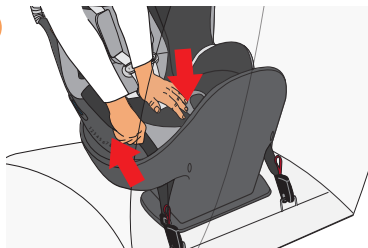



INSTALLING CHILD RESTRAINT WITH LATCH

9. Close Belt Tensioner and use EasyLock to lock it into place.
 - a. Position EasyLock so that notches on arm rest on the tabs on either side of the Belt Tensioner.
 - b. Push down on EasyLock to close Belt Tensioner until it locks in place.
 - c. Store the EasyLock.

NOTE: If Belt Tensioner does not lock, try loosening **LATCH** strap slightly.

9

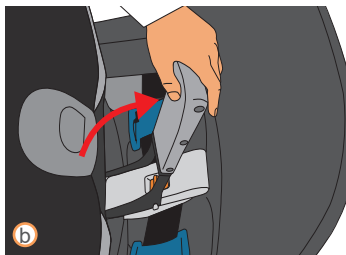
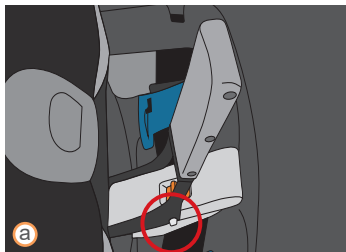



INSTALLING CHILD RESTRAINT WITH LATCH

10. Grab Base near Belt Path and pull side to side and front to back to make sure Base is installed tightly. Base should not move more than 2.5 cm (1 in) side to side or front to back at the Belt Path on the Child Restraint.

If Base moves too much, open Belt Tensioner, tension the **LATCH** Strap a little more and try again. After this, if Base still moves too much, you may need to try a different vehicle seat location or installation method, or both.

11. Replace Belt Path Cover on Base, making sure to insert the tabs at the bottom corners of the cover into the Base before closing. Belt Path Cover will close with an audible **CLICK**.

NOTE: To avoid interference with recline and rotation, ensure the Belt Path Cover is properly closed.

10

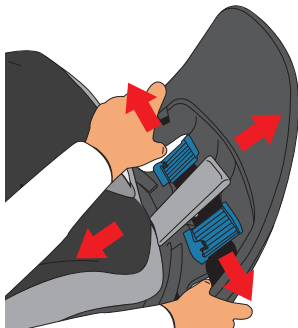

11

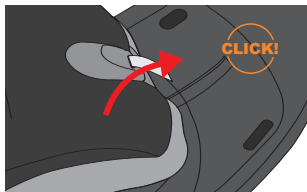



INSTALLING CHILD RESTRAINT WITH LATCH

12. Move Restraint to the appropriate **REAR-FACING** or **FORWARD-FACING** position based on the child's size (pages 8-11) and lock into position. 12

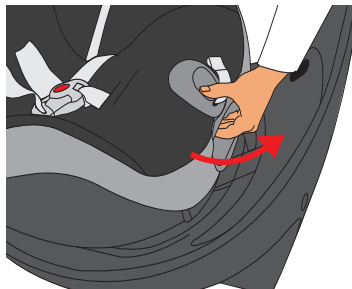

NOTE: Before moving the Restraint to the **FORWARD-FACING** position, you must first remove the Tether from the Tether Storage Compartment on the back of the Restraint.

- a. Rotate the Restraint to the **FORWARD-FACING** position.
- b. Locate the vehicle Tether Anchor and attach the Tether Hook to the Tether Anchor.
- c. Pull the Tether Adjuster Strap to tighten.

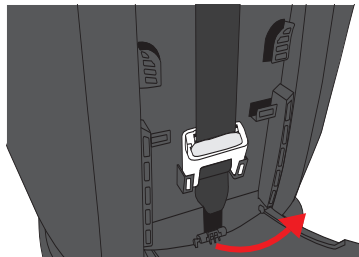



INSTALLING CHILD RESTRAINT WITH LATCH

ALWAYS USE A TETHER FORWARD-FACING if a Tether Anchor is available. A Tether reduces movement of a **FORWARD-FACING** child restraint in a crash and helps to achieve a tight installation. Tether Anchor locations vary from vehicle to vehicle. Refer to your vehicle Owner's Manual for exact locations, anchor identification, and requirements. Refer to page 51 for some common locations.

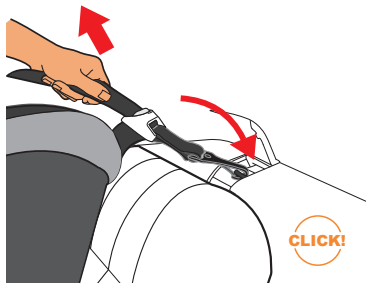

13. Extend Load Leg (page 44).

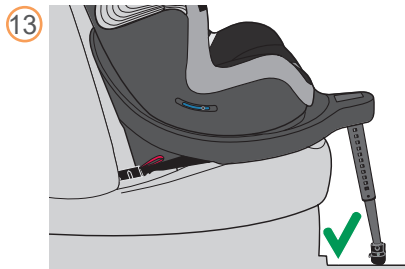



INSTALLING CHILD RESTRAINT WITH LATCH

14. **CHECK** Recline Angle using Level Indicator.

For **REAR-FACING** installation, Recline Ball should be in **BLUE ZONE**.

For **FORWARD-FACING** installation, Recline Ball should be in **RED ZONE**.

⚠ WARNING!
DEATH or SERIOUS INJURY
can occur

Failure to properly recline the child restraint could increase the child's risk of death or serious injury. Infants may have difficulty breathing when in an upright seated position. Make sure they recline enough for their head to lie back comfortably and safely.

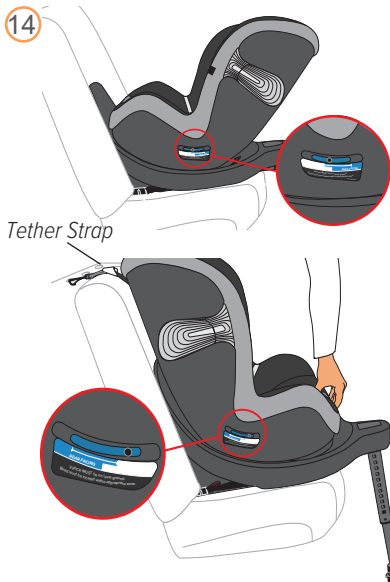



INSTALLING CHILD RESTRAINT WITH LATCH

NOTE: In some vehicles in the most reclined position, it may be necessary to place a rolled towel or small blanket beneath (not behind) the Child Restraint near the seat back to provide enough recline so that the Recline Ball is in the **BLUE ZONE** for **REAR-FACING** use.

NOTE: Only items approved by CYBEX are allowed under Base.

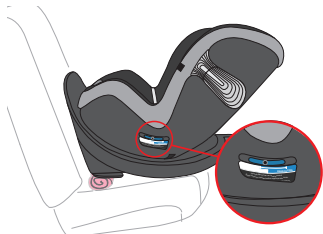

15. Extend L.S.P. toward vehicle door if in an outboard seating position (page 41).

15

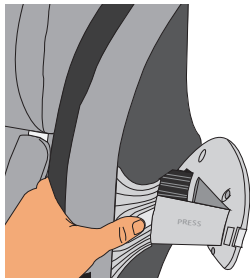



REMOVING CHILD RESTRAINT WITH LATCH

1. To remove **LATCH** Connectors, pull the red **LATCH** Release Straps on both sides of the seat as shown.

If having trouble releasing **LATCH** Connectors, open Belt Tensioner and loosen tension on **LATCH** Connectors by loosening **LATCH** Strap Adjuster.

1

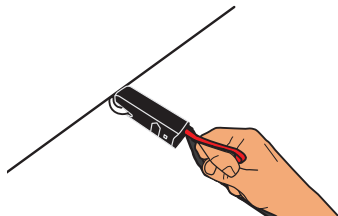



REMOVING CHILD RESTRAINT WITH LATCH

In **FORWARD-FACING LATCH** installations, the following steps must also be completed.

1. Remove the Tether.
 - a. Press Adjuster Release Button.
 - b. Lengthen the Tether Strap.
 - c. Unhook the Tether Strap from the Tether Anchor.
2. Store Tether in Tether Storage Compartment on back of Restraint.
MAKE SURE Tether Storage Compartment door is properly closed after storing.

1

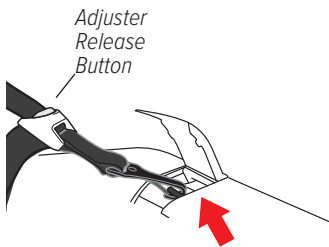

2

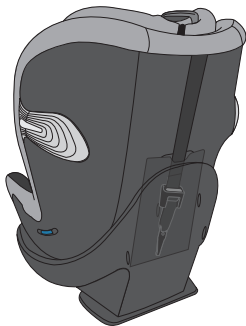



INSTALLING CHILD RESTRAINT WITH LAP/SHOULDER BELT (PREFERRED METHOD)

REAR-FACING: ALWAYS store Tether Strap when using **REAR-FACING**.

FORWARD-FACING: ALWAYS USE A TETHER **FORWARD-FACING** if a Tether Anchor is available.

BEFORE installing Restraint, make sure vehicle is on level ground. Place Restraint on approved vehicle seating location. **MAKE SURE LATCH** Connectors are stored (page 37).

1. Unfold Load Leg from underneath Base.

1

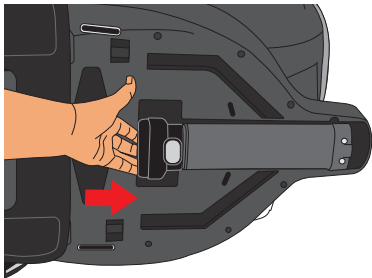



INSTALLING CHILD RESTRAINT WITH LAP/SHOULDER BELT (PREFERRED METHOD)

2. Position Restraint on rear vehicle seat. If a hump is present on vehicle floor, see page 42 for important information on limits of using Load Leg in this seating position.

NOTE: If installing the Restraint with the Load Leg stored, see Overhang Indicator on page 46.

3. Rotate Restraint **REAR-FACING** and move past the most upright position to access the Belt Path (pages 38-39).

2



3





INSTALLING CHILD RESTRAINT WITH LAP/SHOULDER BELT (PREFERRED METHOD)

4. Remove Belt Path Cover from Base.

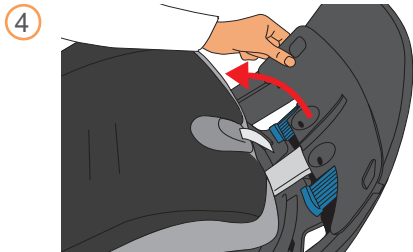

5. Open Belt Tensioner.
a. Pull EasyLock out and up to extend until you hear a CLICK.
b. Slide Lock Button and pull up to open Belt Tensioner in center of Base.

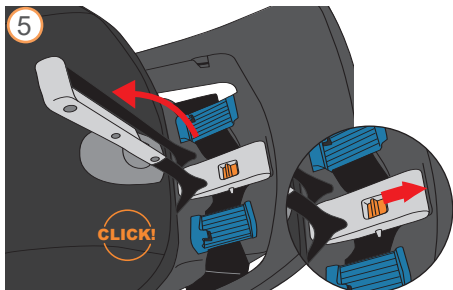



INSTALLING CHILD RESTRAINT WITH LAP/SHOULDER BELT (PREFERRED METHOD)

6. Pull out vehicle belt to form single length of about 60 cm (24 in). Hold Buckle Tongue in one hand and squeeze lap and shoulder belts together in other hand.

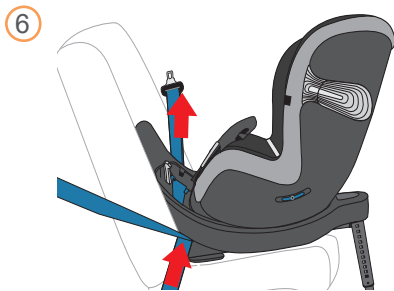

7. Route vehicle belts up through vehicle belt path opening on side of Base, through Belt Guide, under Belt Tensioner, through opposite Belt Guide, and down through opposite belt path opening. **BUCKLE THE BELT.** Make sure belts are underneath tabs on belt guide and lie flat without twisting.

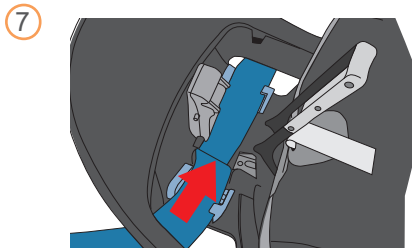

NEVER place vehicle belt over Belt Tensioner, even in a vehicle with longer buckle stalks. This will prevent proper operation of the Child Restraint.



INSTALLING CHILD RESTRAINT WITH LAP/SHOULDER BELT (PREFERRED METHOD)

8. On buckle side, first lift up on shoulder belt to remove slack in lap belt. Then remove slack from shoulder belt on opposite side.

At this point, only remove slack from vehicle belts, being careful not to overtighten them. Belt Tensioner will tighten system fully. If you have previously installed Restraint using **LATCH**, make sure **LATCH** Strap lies flat on bottom of the Base. See “To Store” section on page 37.



Some vehicle lap/shoulder belts have a plastic button or extra fold of webbing on the belt.

Do not allow these to interfere with belt routing through Belt Tensioner. If they interfere:

- Use **LATCH** if within the weight limit, or
- Move the child restraint to a different location.

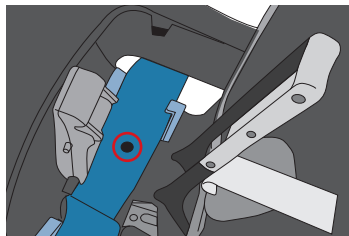



INSTALLING CHILD RESTRAINT WITH LAP/SHOULDER BELT (PREFERRED METHOD)

9. Close Belt Tensioner and use EasyLock to lock it into place.
 - a. Position EasyLock so that notches on arm rest on the tabs on either side of the Belt Tensioner.
 - b. Push down on EasyLock to close Belt Tensioner until it locks in place.
 - c. Store the EasyLock.

NOTE: If Belt Tensioner does not lock, try loosening lap/shoulder belt strap slightly.

9

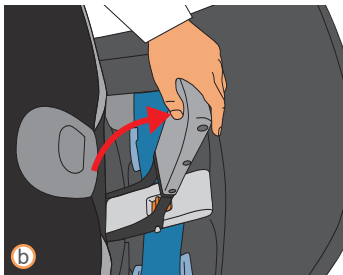



INSTALLING CHILD RESTRAINT WITH LAP/SHOULDER BELT (PREFERRED METHOD)

10. Grab Base near belt path and pull side to side and front to back to make sure Base is installed tightly. Base should not move more than 2.5 cm (1 in) side to side or front to back at the Belt Path on the Child Restraint.

If Base moves too much, open Belt Tensioner, tension vehicle belt a little more and try again. After this, if Base still moves too much, you may need to try a different vehicle seat location or installation method, or both.

In most vehicles, you can switch shoulder belt retractor into locking mode by pulling out shoulder belt all the way and letting it rewind into the retractor. Pull on shoulder belt to make sure it is locking.

NEVER install this Child Restraint using a non-locking vehicle lap/shoulder belt.

NOTE: Refer to your vehicle Owner's Manual for information.

10

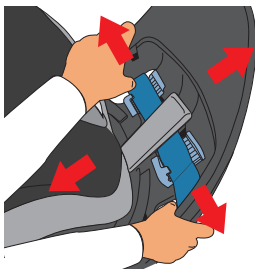



INSTALLING CHILD RESTRAINT WITH LAP/SHOULDER BELT (PREFERRED METHOD)

11. Replace Belt Path Cover on Base, making sure to insert the tabs at the bottom corners of the cover into the Base before closing. Belt Path Cover will close with an audible **CLICK**.

NOTE: To avoid interference with recline and rotation, ensure the Belt Path Cover is properly closed.

11

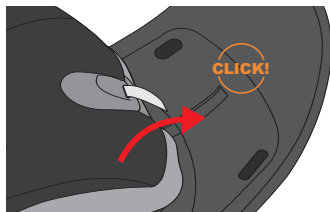

12. Move Restraint to the appropriate **REAR-FACING** or **FORWARD-FACING** position based on the child's size (pages 8-11) and lock into position.

12

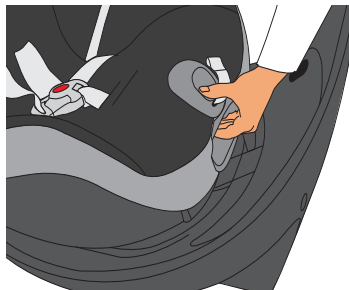



INSTALLING CHILD RESTRAINT WITH LAP/SHOULDER BELT (PREFERRED METHOD)

NOTE: Before moving the Restraint to the **FORWARD-FACING** position, you must first remove the Tether from the Tether Storage Compartment on the back of the Restraint.

- Rotate the Restraint to the **FORWARD-FACING** position.
- Locate the vehicle Tether Anchor and attach the Tether Hook to the Tether Anchor.
- Pull the Tether Adjuster Strap to tighten.

ALWAYS USE A TETHER FORWARD-FACING if a Tether Anchor is available. A Tether reduces movement of a **FORWARD-FACING** child restraint in a crash and helps to achieve a tight installation. Tether Anchor locations vary from vehicle to vehicle. Refer to your vehicle owner's manual for exact locations, anchor identification, and requirements. Refer to page 51 for some common locations.

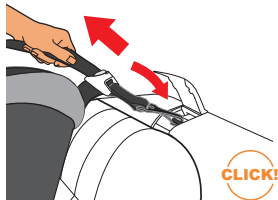
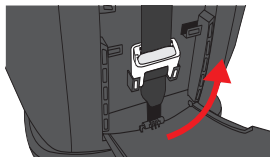

13. Extend Load Leg (page 44).



INSTALLING CHILD RESTRAINT WITH LAP/SHOULDER BELT (PREFERRED METHOD)

14. **CHECK** Recline Angle using Level Indicator.

For **REAR-FACING** installation, Recline Ball should be in **BLUE ZONE**.

For **FORWARD-FACING** installation, Recline Ball should be in **RED ZONE**.

WARNING!
DEATH or SERIOUS INJURY
can occur

Failure to properly recline the child restraint could increase the child's risk of death or serious injury. Infants may have difficulty breathing when in an upright seated position. Make sure they recline enough for their head to lie back comfortably and safely.

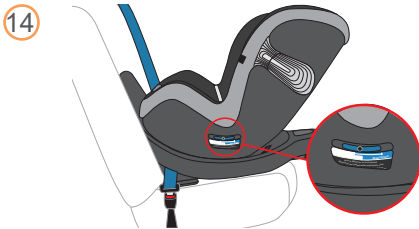

Tether Strap

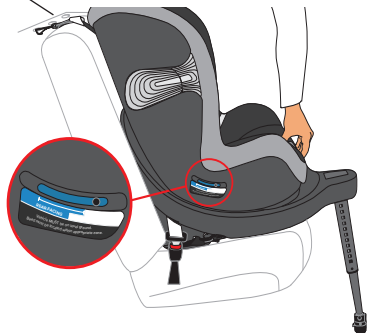



INSTALLING CHILD RESTRAINT WITH LAP/SHOULDER BELT (PREFERRED METHOD)

NOTE: In some vehicles in the most reclined position, it may be necessary to place a rolled towel or small blanket beneath (not behind) the Child Restraint near the seat back to provide enough recline so that the Recline Ball is in the **BLUE ZONE** for **REAR-FACING** use.

NOTE: Only items approved by CYBEX are allowed under Base.

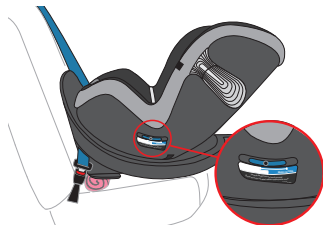

15. Extend L.S.P. toward vehicle door if in an outboard seating position (page 41).

15

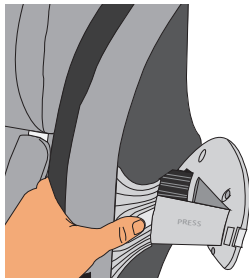



REMOVING CHILD RESTRAINT WITH LAP/SHOULDER BELT

FORWARD-FACING Child Restraint Removal

1. Remove the Tether.
 - a. Press Adjuster Release Button.
 - b. Lengthen the Tether Strap.
 - c. Unhook the Tether Strap from the Tether Anchor.

①

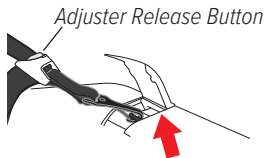

2. Rotate seat **REAR-FACING** and store Tether in Tether Storage Compartment on back of Restraint.

②

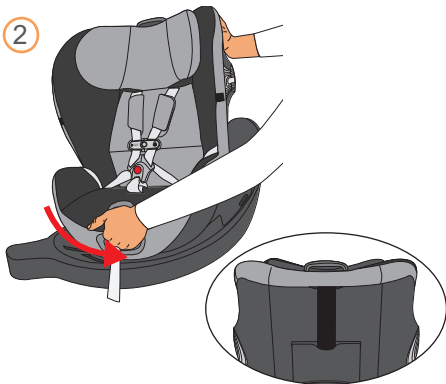

3. Continue with Step #1 of **REAR-FACING** Child Restraint Removal.



REMOVING CHILD RESTRAINT WITH LAP/SHOULDER BELT

REAR-FACING Child Restraint Removal

1. Move the restraint past the most upright position to access the Belt Path (pages 38-39).

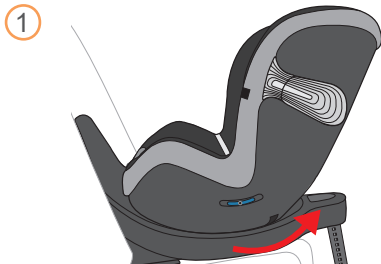

2. Unbuckle the seat belt, remove the Belt Path Cover, and open the Belt Tensioner to release tension.

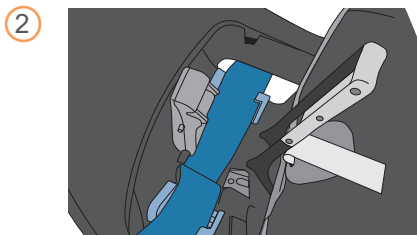



INSTALLING CHILD RESTRAINT WITH LAP BELT

REAR-FACING: ALWAYS store Tether Strap when using **REAR-FACING**.

FORWARD-FACING: ALWAYS USE A TETHER **FORWARD-FACING** if a Tether Anchor is available.

BEFORE installing Restraint, make sure vehicle is on level ground. Place Restraint on approved vehicle seating location. **MAKE SURE LATCH** Connectors are stored (page 37).

1. Unfold Load Leg from underneath Base.

1

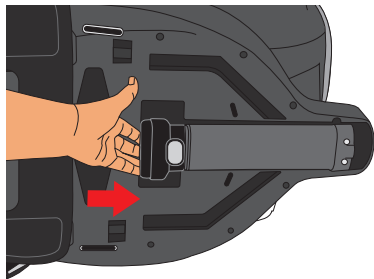



INSTALLING CHILD RESTRAINT WITH LAP BELT

2. Position Restraint on rear vehicle seat. If a hump is present on vehicle floor, see page 42 for important information on limits of using Load Leg in this seating position.

NOTE: If installing the Restraint with the Load Leg stored, see Overhang Indicator on page 46.

2



3. Rotate Restraint **REAR-FACING** and move past the most upright position to access the Belt Path (pages 38-39).

3





INSTALLING CHILD RESTRAINT WITH LAP BELT

4. Remove Belt Path Cover from Base.

4

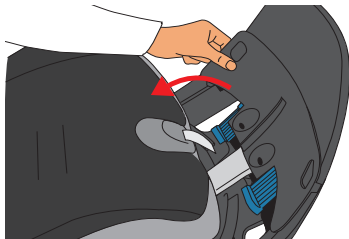

5. Open Belt Tensioner.
- Pull EasyLock out and up to extend until you hear a CLICK.
 - Slide Lock Button and pull up to open Belt Tensioner in center of Base.

5

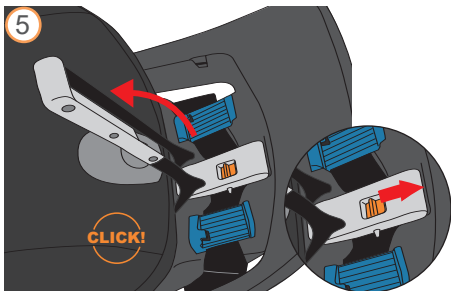



INSTALLING CHILD RESTRAINT WITH LAP BELT

6. Route vehicle belt up through vehicle belt path opening on side of Base, through Belt Guide, under Belt Tensioner, through opposite Belt Guide, and down through opposite belt path opening. **BUCKLE THE BELT.** Make sure belts are underneath tabs on belt guide and lie flat without twisting.



NEVER install this Child Restraint using a non-locking vehicle lap belt (page 26).

NEVER place vehicle belt over Belt Tensioner, even in a vehicle with longer buckle stalks. This will prevent proper operation of the Child Restraint.

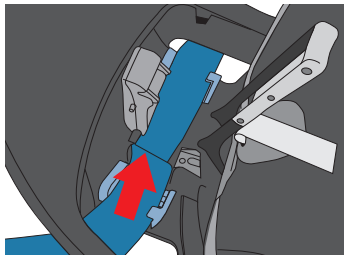



INSTALLING CHILD RESTRAINT WITH LAP BELT

7. Pull up on free end of belt to tighten. At this point, only remove slack from vehicle belt, being careful not to overtighten it. Belt Tensioner will tighten system fully.

If you have previously installed Restraint using **LATCH**, make sure **LATCH** Strap lies flat on bottom of the Base and is not overtightened. See “To Store” section on page 37.

NOTE: To store excess belt after tightening, place the free end of belt flat under Base.

NOTE: Only items approved by CYBEX are allowed under Base.

7





INSTALLING CHILD RESTRAINT WITH LAP BELT

8. Close Belt Tensioner and use EasyLock to lock it into place. 8
- Position EasyLock so that notches on arm rest on the tabs on either side of the Belt Tensioner.
 - Push down on EasyLock to close Belt Tensioner until it locks in place.
 - Store the EasyLock.

NOTE: If Belt Tensioner does not lock, there may be too much tension in the lap belt or LATCH strap. Check both and loosen as needed before attempting to re-lock.

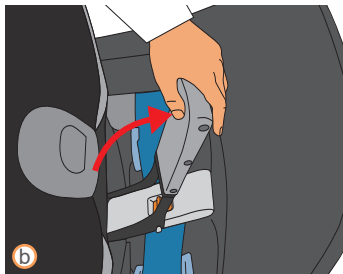



INSTALLING CHILD RESTRAINT WITH LAP BELT

9. Grab Base near belt path and pull side to side and front to back to make sure Base is installed tightly. Base should not move more than 2.5 cm (1 in) side to side or front to back at the Belt Path on the Child Restraint.

If Base moves too much, open Belt Tensioner, tension vehicle belt a little more and try again. After this, if Base still moves too much, you may need to try a different vehicle seat location or installation method, or both.

9

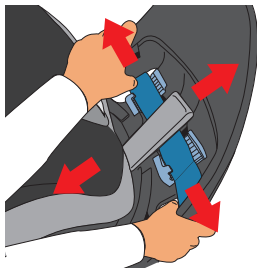

INSTALLING CHILD RESTRAINT WITH LAP BELT



10. Replace Belt Path Cover on Base, making sure to insert the tabs at the bottom corners of the cover into the Base before closing. Belt Path Cover will close with an audible **CLICK**.

NOTE: To avoid interference with recline and rotation, ensure the Belt Path Cover is properly closed.

11. Move Restraint to the appropriate **REAR-FACING** or **FORWARD-FACING** position based on the child's size (pages 8-11) and lock into position.

10

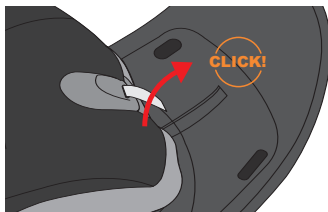

11

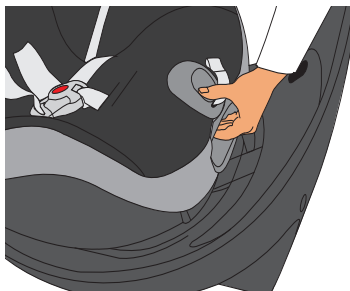



INSTALLING CHILD RESTRAINT WITH LAP BELT

NOTE: Before moving the Restraint to the **FORWARD-FACING** position, you must first remove the Tether from the Tether Storage Compartment on the back of the Restraint.

- Rotate the Restraint to the **FORWARD-FACING** position.
- Locate the vehicle Tether Anchor and attach the Tether Hook to the Tether Anchor.
- Pull the Tether Adjuster Strap to tighten.

ALWAYS USE A TETHER FORWARD-FACING if a Tether Anchor is available. A Tether reduces movement of a **FORWARD-FACING** child restraint in a crash and helps to achieve a tight installation. Tether Anchor locations vary from vehicle to vehicle. Refer to your vehicle owner's manual for exact locations, anchor identification, and requirements. Refer to page 51 for some common locations.

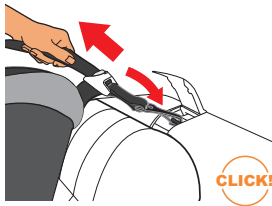
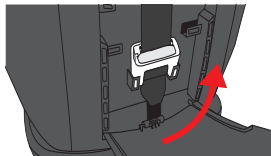

12



12. Extend Load Leg (page 44).



INSTALLING CHILD RESTRAINT WITH LAP BELT

13. **CHECK** Recline Angle using Level Indicator.

For **REAR-FACING** installation, Recline Ball should be in **BLUE ZONE**.

For **FORWARD-FACING** installation, Recline Ball should be in **RED ZONE**.

WARNING!
DEATH or SERIOUS INJURY
can occur

Failure to properly recline the child restraint could increase the child's risk of death or serious injury. Infants may have difficulty breathing when in an upright seated position. Make sure they recline enough for their head to lie back comfortably and safely.

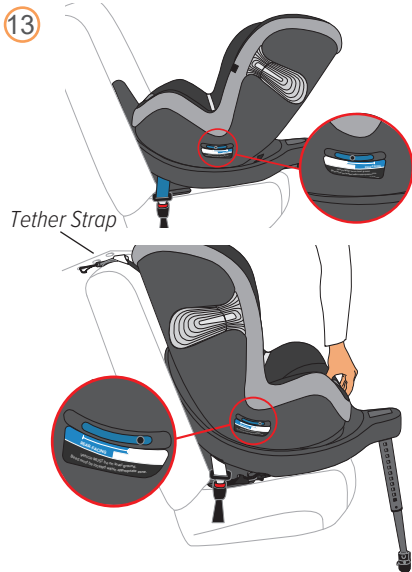



INSTALLING CHILD RESTRAINT WITH LAP BELT

NOTE: In some vehicles in the most reclined position, it may be necessary to place a rolled towel or small blanket beneath (not behind) the Child Restraint near the seat back to provide enough recline so that the Recline Ball is in the **BLUE ZONE** for **REAR-FACING** use.

NOTE: Only items approved by CYBEX are allowed under Base.

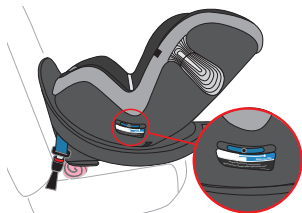

14. Extend L.S.P. toward vehicle door if in an outboard seating position (page 41).

14

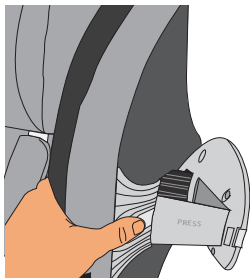



REMOVING CHILD RESTRAINT WITH LAP BELT

FORWARD-FACING Child Restraint Removal

1. Remove the Tether.
 - a. Press Adjuster Release Button.
 - b. Lengthen the Tether Strap.
 - c. Unhook the Tether Strap from the Tether Anchor.
2. Rotate seat **REAR-FACING** and store Tether in Tether Storage Compartment on back of Restraint.

MAKE SURE Tether Storage Compartment door is properly closed after storing.

3. Continue with Step #1 of **REAR-FACING** Child Restraint Removal.

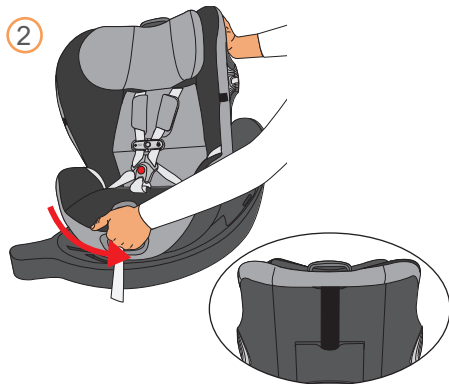
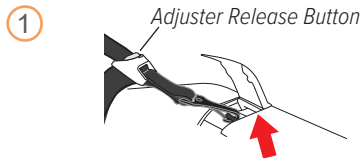

REMOVING CHILD RESTRAINT WITH LAP BELT



REAR-FACING Child Restraint Removal

1. Move the restraint past the most upright position to access the Belt Path (pages 38-39).

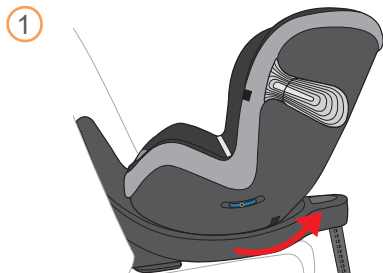

2. Unbuckle the seat belt, remove the Belt Path Cover, and open the Belt Tensioner to release tension.

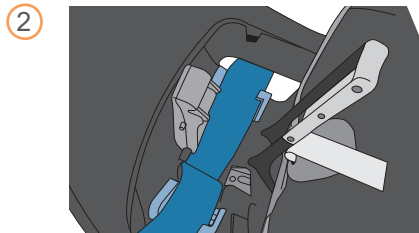

SECURING CHILD WITH HARNESS

1. Loosen harness by firmly pressing down on the Harness Adjustment Button while pulling forward on both Harness Straps at shoulder level.

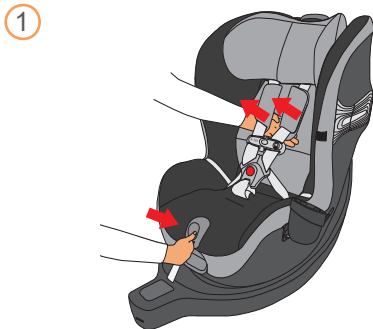

2. If Chest Clip is closed:
 - a. Press red button on Harness Buckle (a) to release Buckle Tongues.
 - b. Separate Chest Clip (b) and spread Harness Straps apart.
 - c. Secure Harness Buckles to seat using Magnetic Buckle Tongue Holders.

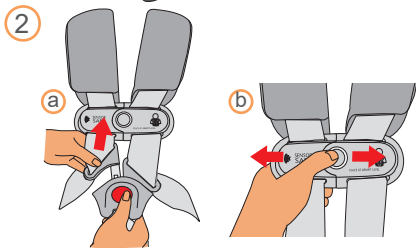

NOTE: To preserve battery life, always store the SensorSafe Chest Clip in the unclipped position.

⚠️ **WARNING!** DEATH or SERIOUS INJURY can occur

- **NEVER** secure child in Child Restraint with child dressed in bulky or heavy clothing. Heavy clothing can prevent Harness from being properly tightened around the child.
- **NEVER** secure child in Child Restraint with child wrapped in a blanket. To keep child warm, place a blanket over the child **AFTER** you have properly secured and tightened Harness around the child.

3. Place child in Child Restraint with child's back and bottom flat against the Restraint. Pull Harness Straps over the child's shoulders and around the child's waist. Straps must lie flat, free of twists, and in the center of the child's shoulders.

NOTE: If Crotch Strap is under the child, it will need to be adjusted (page 47).

To ensure a better fit with smaller infants, the Newborn Insert may need to be used. **NEVER** place extra padding under or behind the child. **ONLY USE** the Newborn Insert that comes with your original car seat or one that has been specifically designed for it by CYBEX.

3

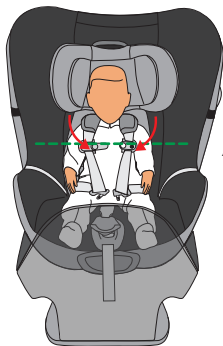

*Chest Clip at
Armpit Level*

SECURING CHILD WITH HARNESS

- Adjust the Headrest height so that the Harness Straps are positioned properly (page 94).

4

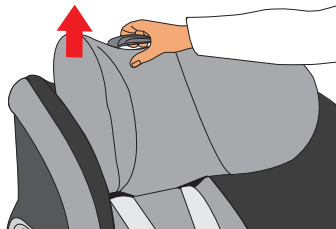

NOTE: If using the lower Headrest/Harness positions, make sure to tuck the excess Headrest Flap up behind the Headrest Pad. The Headrest Flap is designed with two fold lines to allow for partial or full storage behind the Headrest Pad.

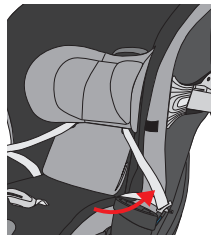
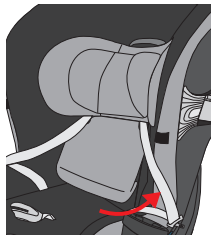

SECURING CHILD WITH HARNESS

REAR-FACING

Position the Harness Straps **AT or JUST BELOW** the child's shoulders.

NOTE: Child's Head **MUST** be 2.5 cm (1 in) or more below the top of the Headrest or shell, whichever is higher.

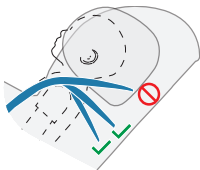

FORWARD-FACING

Position the Harness Straps **AT or JUST ABOVE** the child's shoulders.

NOTE: Top of Child's ears **MUST** be below the top of the Headrest.

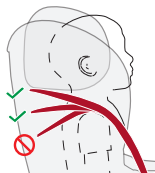

SECURING CHILD WITH HARNESS

5. Fasten buckle by inserting one tongue at a time into the Harness Buckle listening for an audible **CLICK**. Pull up firmly on both Buckle Tongues to make sure they are securely latched.

CHECK that the Buckle functions properly and is kept free of dirt and debris.

Make sure Harness Straps are not twisted.

5

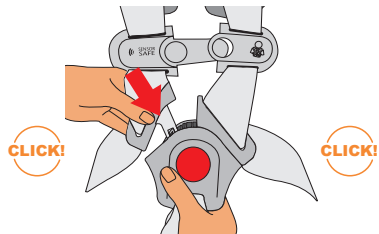

6. Fasten Chest Clip by snapping both sides together. Listen for a **CLICK**.

6

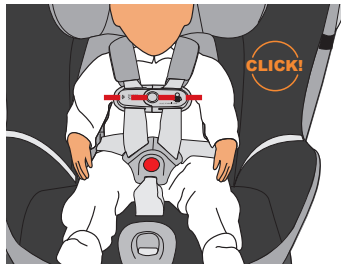

SECURING CHILD WITH HARNESS

7. Push Chest Clip and shoulder pads down away from the child's neck and towards the Harness Buckle.

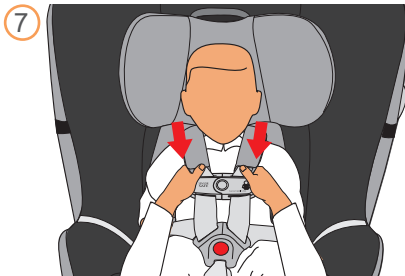

8. Pull up on both shoulder straps to remove all slack from the child's hips.

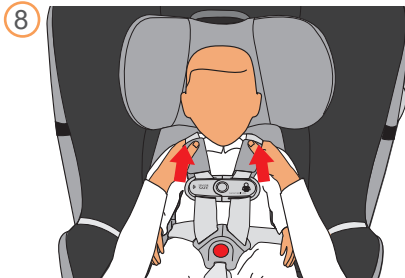

SECURING CHILD WITH HARNESS

9. Slowly pull the Adjuster Strap to tighten the Harness Straps while holding the Chest Clip so that it does not ride up into child's neck. **If you can pinch the Strap** at the child's shoulders, the **Harness is too loose**.

To tighten, pull the Harness Adjuster Strap until Harness is snug on the child. A snug strap should not allow any slack. It lies in a relatively straight line without sagging. It does not press on the child's flesh or push the child's body into an unnatural position.

10. Position Chest Clip at armpit level as shown.

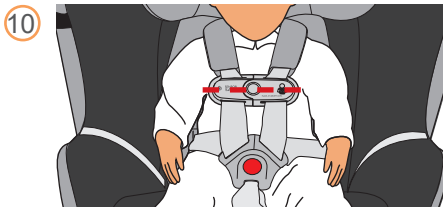
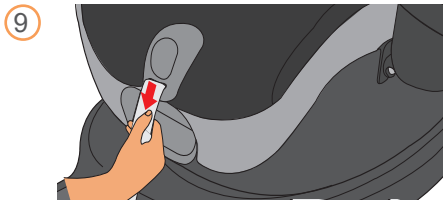

SECURING CHILD WITH HARNESS

11. To loosen Harness, firmly press down the Harness Adjustment Button while pulling forward on both Harness Straps at shoulder level.

11

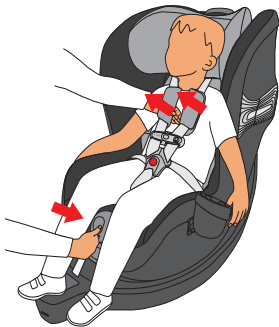

12. To remove child, press center buttons on Chest Clip and Harness Buckle and pull them apart.
13. Secure Harness Buckles to seat using Magnetic Buckle Tongue Holders.

12

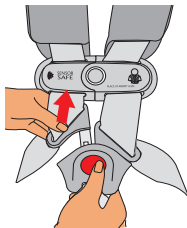

NOTE: To preserve battery life, always store the SensorSafe Chest Clip in the unclipped position.

REMOVING THE SHOULDER PADS

Unsnap and remove Shoulder Pads as shown at right.

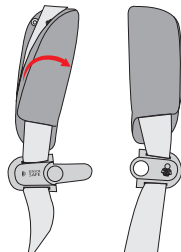

REPLACING THE SHOULDER PADS

Re-attach Shoulder Pads by folding the snaps over the Harness Strap and securing both snaps. Make sure they are oriented as shown.

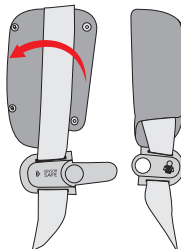

⚠️ WARNING! DEATH or SERIOUS INJURY can occur

- The Child Restraint must **NEVER** be used without the Seat Cover.
- **DO NOT** damage, remove or dispose of any EPP foam padding on the Sirona S.

REMOVING THE SEAT COVER

1. Adjust the Headrest to its highest position (a).
2. Unzip the back of the Headrest Cover (b) and unsnap from the back of the seat.
3. If using the Newborn Headpad Insert (c), remove from the Headrest.
4. Unsnap and remove the Shoulder Pads (d).
5. Unfasten the Chest Clip (e).
6. Unfasten the Harness Buckle (f).
7. If using the Newborn Insert (g), remove it.
8. If using the Buckle Pad (h), remove it.

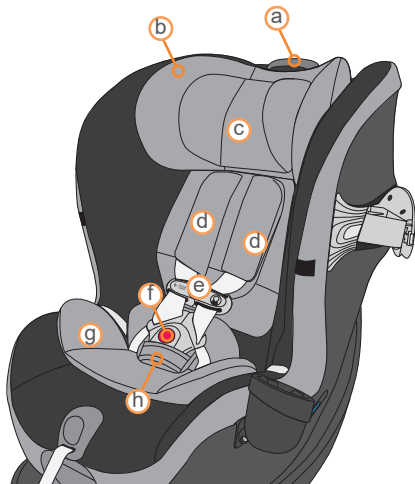

CARE AND CLEANING

9. Remove the Headrest Cover from the Headrest.

9

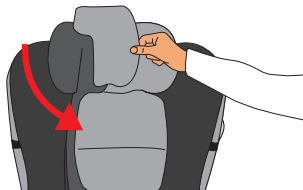

10. Remove the Seat Cover from the Child Restraint.

10

- Unsnap the two snaps securing the Back Padding to the Seat Cover and pull forward.
- Untuck Seat Cover from around the edges of the seat and pull the Seat Cover away from the Child Restraint.

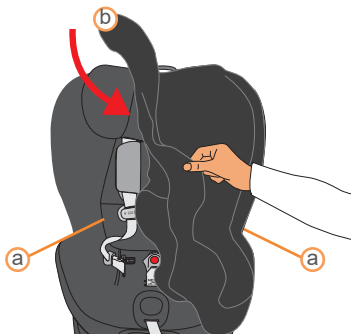

CARE AND CLEANING

INSTALLING THE SEAT COVER

1. Install the Seat Cover onto the Child Restraint.
 - a. From the top of the seat, tuck the Seat Cover around the edges of the Child Restraint.
 - b. Secure the two snaps on the Back Padding to the Seat Cover.

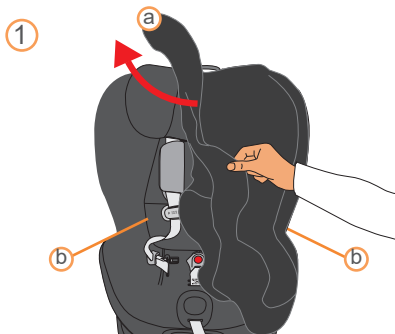

2. Install the Headrest Cover to the Headrest.

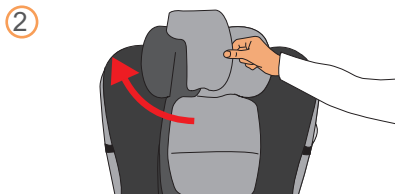

CARE AND CLEANING

3. Zip the back of the Headrest Cover **(a)** and secure the snap on the Headrest Cover through the Headrest Height Adjustment Handle to the back of the seat.
4. If using the Newborn Headpad Insert **(b)**, secure it to the Headrest.
5. Install the Shoulder Pads **(c)**.
6. Fasten the Chest Clip **(d)**.
7. If using the Newborn Insert **(e)**, reinstall it.
8. If using the Buckle Pad **(f)**, reinstall it.
9. Fasten the Harness Buckle **(g)**.

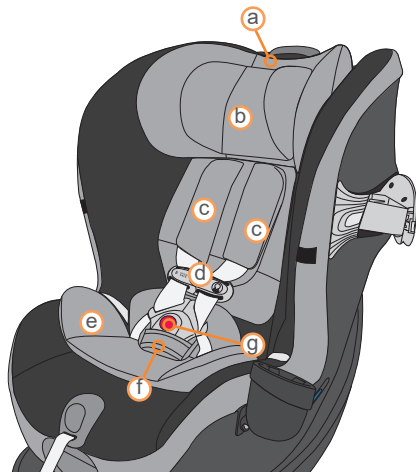

CARE AND CLEANING

REMOVING THE HARNESS STRAPS

1. Adjust the Headrest to its highest position.

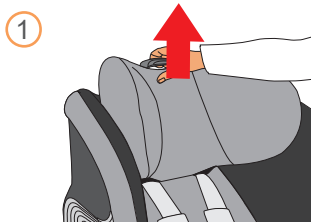

2. Press red button on Harness Buckle to release tongues.
3. Separate Chest Clip and spread Harness Straps apart.

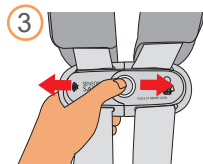
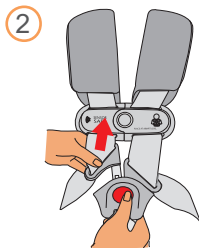

CARE AND CLEANING

4. Unfasten the two snaps securing the Headrest Cover to the seat and move the Harness Straps off to the sides.

NOTE: Secure the harness buckles to the seat using the Magnetic Buckle Tongue Holders.

4



5. Unfasten the two snaps securing the Back Padding to the Seat Cover and pull forward to expose Seat Pan.

5

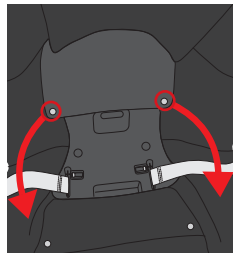

CARE AND CLEANING

6. Remove Harness Straps from Seat Pan.
- Push up on Hip Anchor Retention Tab **a** and slide Hip Anchor Pin **b** inward.
 - Remove Harness Strap from Hip Anchor and repeat at other side.

6

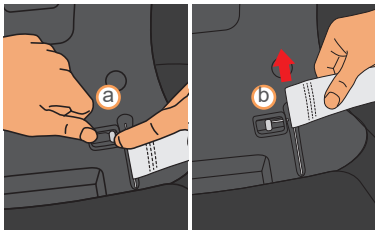

7. Remove Harness Straps from Child Restraint.
- Loosen Harness Straps **a** by pulling forward until Splitter Plate **b** is visible.
 - Disconnect Harness Straps from Splitter Plate.
 - Drape Splitter Plate into Seat Pan to prevent falling into bottom of Child Restraint.

7

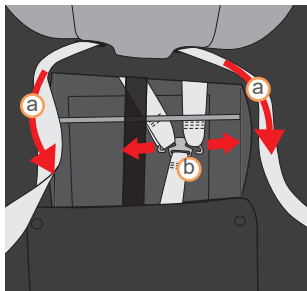

REPLACING THE HARNESS STRAPS

1. Feed the Harness Straps through the Harness Slots located on the back of the Child Restraint.

1

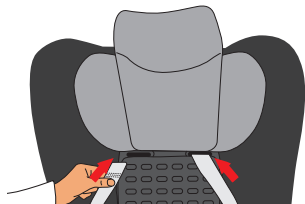

2. Lift up the seat back and ensure that the Harness Straps feed behind the Harness Load Bar.

NOTE: The Tether Strap should be in front of the Harness Load Bar.

2

Harness Load Bar

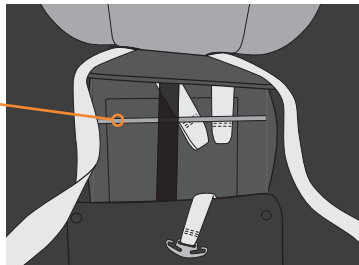

CARE AND CLEANING

3. Attach Harness Straps to Splitter Plate.

NOTE: Make sure straps are not twisted and fully attached to the Splitter Plate as shown to prevent detachment.

③

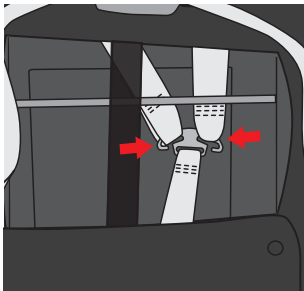

4. Attach Harness Strap to Seat Pan.
a. Attach Harness Strap to hip anchor.
b. Slide hip anchor pin **a** outward to lock and repeat at other side.

NOTE: Make sure straps are not twisted and fully attached to the Seat Pan as shown.

④

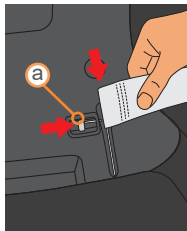

5. Secure the two snaps on the Back Padding to the Seat Cover.
6. Reinsert the Harness Straps through the loops connecting the Headrest Cover to the seat and close the two snaps.

CARE AND CLEANING

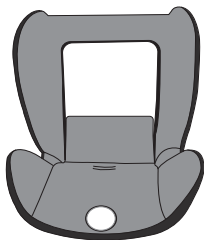

Seat Cover

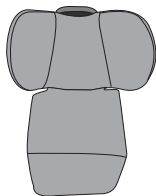

Headrest Cover



Newborn Insert

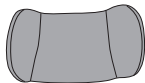

*Newborn
Headpad Insert*



Shoulder Pads



Buckle Pad

SPOT CLEANING

Spot clean Seat Covers, Shoulder Pads, Buckle Pad, and Newborn Inserts as needed with a clean cloth using mild detergent and water.

WASHING INSTRUCTIONS

All seat cover parts can be washed as follows:

- Machine wash separately in COLD water, delicate cycle, with mild detergent.
- Drip-dry.

TO AVOID SHRINKAGE:

- **DO NOT** machine wash warm or hot.
- **DO NOT TUMBLE DRY.**
- **DO NOT** iron.
- **DO NOT** use bleach.

CARE AND CLEANING

SENSORSAFE CHEST CLIP

- **DO NOT SUBMERGE IN WATER.** Wipe clean with mild detergent and warm water.

HARNESS BUCKLE

Food, drink or other debris may collect inside the Harness Buckle which can affect proper function.

- **DO NOT SUBMERGE THE BUCKLE STRAP IN WATER.**
- Wipe clean with a damp cloth.
- **DO NOT** use bleach, detergents or lubricants.
- When inserting the Buckle Tongues, be sure you can hear an audible **CLICK** to make sure the buckle is working properly.
- **DO NOT** use the Child Restraint if the Buckle Tongues **DO NOT** click into the buckle. Try cleaning the buckle. If this does not remedy the problem, please call Customer Service 1-877-242-5676 before using the Child Restraint.

HARNESS STRAPS

- **NEVER SUBMERGE THE LOWER ANCHOR STRAPS OR HARNESS STRAPS.**
- Sponge clean using warm water and mild soap.
- Air dry.
- **DO NOT** iron.

LOWER ANCHOR CONNECTORS

- Sponge clean or thoroughly rinse Lower Anchor Connectors with warm water.
- Allow to dry thoroughly.
- Test by connecting and disconnecting until an audible **CLICK** is heard after attaching each connector to a lower anchor. If clicks are not heard, repeat the cleaning procedure.

PLASTIC PARTS

- Wipe clean with mild detergent and warm water.

⚠️ **WARNING!** DEATH or SERIOUS INJURY can occur

This product contains magnets. Before use, consult your family doctor about the compatibility of this product with pacemakers and similar devices.

Secure your child into the child restraint as you would normally. The SensorSafe Receiver Plug monitors both the Chest Clip Transmitter and the vehicle. When you arrive at your destination and turn your vehicle off, the SensorSafe system sounds a series of gentle tones reminding you that your baby is in the vehicle. Install it once and SensorSafe is always ready to alert you.

IMPORTANT USAGE INFORMATION

- The SensorSafe system consists of two components: (1) The Chest Clip Transmitter and (2) The Receiver Plug. The system will not work unless both of these components are present in the vehicle with the Receiver installed in the vehicle's OBDII port (page 115).



CHEST CLIP TRANSMITTER



RECEIVER PLUG

- This system works with the SensorSafe Application which can be downloaded from: The App Store® or Google Play™.*

* Trademarks are the property of their respective owners.

GENERAL INFORMATION ABOUT SENSORSAFE®

- The SensorSafe Chest Clip is designed to go into a sleep mode after being clipped for 12 hours. Although 12-hour vehicle trips without stops are uncommon and not recommended, the Chest Clip must be opened and closed after 12 hours to reactivate the SensorSafe system.
- The Receiver Plug has **ONLY** been tested with 2008 or newer vehicles purchased in the U.S. or Canada. If you would like to use the SensorSafe Chest Clip with a Hybrid or Electric vehicle, you will need to download the application from the App Store® or Google Play™.* Additional Receiver Plugs can be purchased for additional vehicles. If you have questions, please download the SensorSafe app or contact CYBEX at: 1-877-242-5676 or online at: <http://cybex-online.com/us/contact.html>.

BATTERY USAGE

- **TO PRESERVE BATTERY LIFE, ALWAYS STORE THE SENSORSAFE CHEST CLIP IN THE UNCLIPPED POSITION.**
- The Chest Clip ships with 1-button cell lithium battery installed that can be replaced.
- The SensorSafe is designed to alert you of a low battery. If your Chest Clip battery is getting low, the SensorSafe Receiver will make a “low battery” alarm and LED will flash 10 times when the Chest Clip is fastened. This “low battery” alarm will sound different from the beeps you typically hear when activating your SensorSafe system. The SensorSafe Chest Clip uses a Panasonic™ CR2032 Lithium button cell Battery. Should you have problems with SensorSafe hardware, please contact CYBEX at: 1-877-242-5676 or online at: <http://cybex-online.com/us/contact.html> to order a replacement battery/parts.

* Trademarks are the property of their respective owners.

SensorSafe® Technology

Questions? Comments?:

Visit us at: <http://cybex-online.com/us/contact.html> or call CYBEX at: 1-877-242-5676

This device meets the requirements of SAE J3005.

FCC CERTIFIED:

Chest Clip Model: SOSR2, FCC ID: 2ABS2-SOSR3

Receiver Plug Model: SS2, FCC ID: 2ABS2-SS2

This device complies with Part 15 of the FCC Rules. Operation is subject to the following two conditions:

1. This device may not cause harmful interference.
2. This device must accept any interference received, including interference that may cause undesired operation.

⚠ WARNING! DEATH or SERIOUS INJURY can occur

Changes or modifications not expressly approved by the party responsible for compliance could void the user's authority to operate the equipment.

NOTE: This equipment has been tested and found to comply with the limits for a Class B digital device, pursuant to Part 15 of the FCC Rules. These limits are designed to provide reasonable protection against harmful interference in a residential installation.

This equipment generates, uses, and can radiate radio frequency energy and, if not installed and used in accordance with the instructions, may cause harmful interference to radio communications. However, there is no guarantee that interference will not occur in a particular installation. If this equipment does cause harmful interference to radio or television reception, which can be determined by turning the equipment off and on, the user is encouraged to try to correct the interference by one or more of the following measures:

- Reorient or relocate the receiving antenna.
- Increase the separation between the equipment and receiver.
- Connect the equipment into an outlet on a circuit different from that to which the receiver is connected.
- Consult the dealer or an experienced radio/TV technician for help.

Chest Clip:

RF warning statement: The device has been evaluated to meet general RF exposure requirement. The device can be used in portable exposure condition without restriction.

Receiver Plug:

FCC Radiation Exposure Statement: This equipment complies with FCC radiation exposure limits set forth for an uncontrolled environment. This equipment should be installed and operated with minimum distance 20 cm (7.87 in) between the radiator & your body.

1. INSTALL THE SENSORSAFE RECEIVER.

Locate the 16PIN OBDII port **a** in your vehicle. Refer to your vehicle Owner's Manual for location. Plug in the SensorSafe Receiver. If unable to locate your vehicle manual, the SensorSafe Application may contain information regarding the location of the 16PIN OBDII port for your vehicle.

Your SensorSafe Receiver will sound when it first communicates with the vehicle network. In some vehicles this occurs immediately after installing the SensorSafe Receiver. In other vehicles the tone will not be heard until the vehicle has been started.

This initialization signal only occurs one time after installation.

2. POWER UP THE VEHICLE.

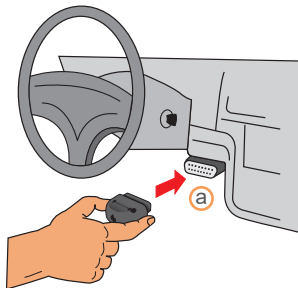

USING SENSORSAFE®

3. CYCLE THE SENSORSAFE CHEST CLIP.

Your SensorSafe Chest Clip is designed to “go to sleep” if left fastened for more than 12 hours. To reset, or “wake up” the Chest Clip, unfasten then re-fasten it. When you do this, the blue LED will flash two times.

TO PRESERVE BATTERY LIFE, ALWAYS STORE THE SENSORSAFE CHEST CLIP IN THE UNCLIPPED POSITION.

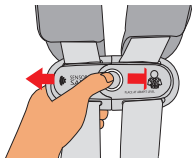

4. DRIVE THE VEHICLE.

The SensorSafe Receiver is designed to respond after the vehicle has been driven at 8 km (5 miles) per hour or more.

5. PARK THE VEHICLE AND TURN OFF THE IGNITION.

Within 2 seconds of parking your vehicle and turning off the ignition you will hear the SensorSafe reminder, alerting you that your baby is in the vehicle. If you don't hear the reminder tone, test your SensorSafe by following steps 1-5 again. Contact CYBEX at: 1-877-242-5676 or online at: <http://cybex-online.com/us/contact.html> if the reminder tone again fails to sound.

NOTE: SensorSafe Receiver will also alarm if your child unclips the Chest Clip after the vehicle has been driven at 8 km (5 miles) per hour or more, but only if the vehicle is on.

REPLACING THE SENSORSAFE CHEST CLIP BATTERY.

1. Loosen Harness by pressing Harness Release Button on the front of the Child Restraint and pulling forward on both Harness Straps.
2. Unbuckle Harness by pressing the button on the Crotch Buckle and pulling out both Buckle Tongues.
3. Open Chest Clip by pressing the Release Button and pulling the Chest Clip apart.

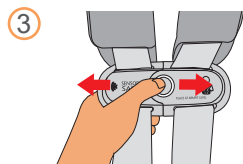
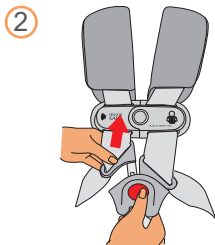
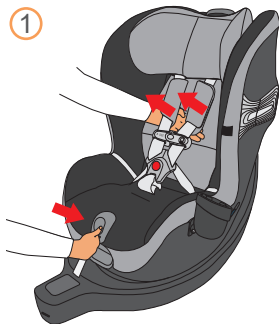

USING SENSORSAFE®

- Turn the male side of the Chest Clip over and loosen screws with a small Phillips screwdriver. Remove the cover (a).
- Remove Circuit Board (b) from Chest Clip. Remove Battery (c) from Circuit Board. Replace Battery with new Panasonic™ CR2032 Lithium button cell Battery, as shown.
- Place the Circuit Board with the new Battery in the Chest Clip. Replace the Cover and tighten the screws. This completes the battery replacement process.

If you have questions, please contact CYBEX at: 1-877-242-5676 or online at:

<http://cybex-online.com/us/contact.html>.

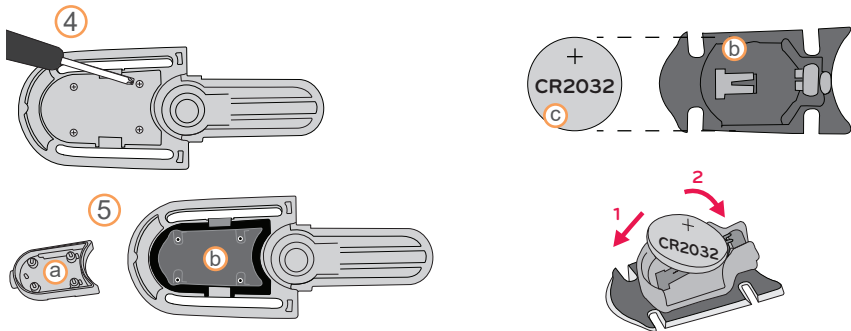

* Trademarks are the property of their respective owners.

SAFETY CHECKLIST

- Did you read and understand this Owner's Manual and all labels found on this Child Restraint?
- Is the Child Restraint positioned correctly (**REAR-FACING**/**FORWARD-FACING**) for the child's size?
- Is the seat recline angle correct according to the Level Indicator?
- Does the Rotation Lock Indicator display the word LOCKED?
- Did you check for hot surfaces in sunny weather?
- Is the Harness adjusted to the correct position for the size of the child with the Harness **AT or JUST BELOW** child's shoulders (**REAR-FACING**), or **AT or JUST ABOVE** child's shoulders (**FORWARD-FACING**)?
- Is the Harness snug around the child and secured properly with the Chest Clip positioned at armpit level?
- Is the Tether Strap being used when using the seat **FORWARD-FACING**?
- Is the Load Leg resting firmly against the vehicle floor and does the Load Leg Lock Indicator display the color **GREEN**?
- If the Child Restraint is next to a vehicle door or panel, is the adjacent L.S.P. device extended?
- Does your child meet the Child Usage Guidelines for the seat (pages 8-11)?
- Is today's date before the "Do Not Use After" date on the Child Restraint?
- If you answered YES to all of these questions, you are good to go. Please **DRIVE SAFELY!**

RESOURCES

IF YOU NEED HELP

Please contact our Customer Care Department, where we have many Child Passenger Safety (CPS) Technicians on staff, with any questions you may have concerning installation, parts, maintenance, or warranty information.

When you contact us, please have the Model Number and Manufactured on Date ready so that we may help you efficiently. This information can be found on the underside of your Child Restraint Base.

Please contact CYBEX Customer Care at 1-877-242-5676.

E-mail: support.americas@goodbabyint.com

Web: www.cybex-online.com

RESOURCES

Additional information, tips, and installation videos can be found in the SensorSafe mobile app.

75% OF ALL CAR SEATS ARE INSTALLED INCORRECTLY!

Installing your car seat correctly in your vehicle is extremely important for your child's safety. Make sure your car seat is installed correctly by using one of the following resources:

www.nhtsa.gov/equipment/car-seats-and-booster-seats

www.safekids.org

To find an available CPS Technician in your area, go to bit.ly/FindATech

Recycling : Once your seat has reached its expiration date, we recommend recycling the seat. Contact your local community recycling center for the best way to dispose of your seat. We do not recommend giving or selling the seat to anyone, or simply putting it in the garbage.

WARRANTY

IMPORTANT: Immediately register your Child Restraint so we can contact you in the unlikely event of a safety recall. Register online at <http://register.cybex-online.com/us/carseats>, or mail in the separate registration card provided.

LIMITED WARRANTY

CYBEX warrants to the original consumer purchaser that this product will be free from defects in material and workmanship for two (2) years from the date of original purchase (the“Warranty Period”). During the Warranty Period, CYBEX, at its option, may repair or replace this product if it is found by the manufacturer to be defective in material or workmanship. CYBEX reserves the right to discontinue or change parts, fabrics, models, or products, or to substitute this product with a comparable model or product. To make a claim under this warranty, please contact us at info.us@cybex-online.com, call us at 1-877-242-5676, or write to us at:

CYBEX Warranty
Columbus Trading Partners USA, Inc.
1801 Commerce Drive
Piqua, Ohio 45356

An original receipt is required to validate your warranty, and shipping charges will be the responsibility of the original consumer purchaser. To expedite the processing of any future warranty claims and to verify the original date of purchase, please complete and mail the pre-addressed owner registration card within thirty (30) days of purchase.

WARRANTY LIMITATIONS

This warranty does not cover the effects of normal wear and tear or damages resulting from negligence, modification, improper installation, accidents, misuse, or abuse of this product. It is expressly agreed that the obligations of CYBEX and the original consumer purchaser's remedies under the limited warranty contained herein are exclusive and are strictly limited to the repair or replacement of the product.

This limited warranty is conditional upon strict compliance with the provisions of the Owner's Manual. In no event will CYBEX or the dealer selling this product be liable to you for any damages, including incidental or consequential damages, arising out of the use or inability to use this product.

LIMITATION OF WARRANTIES AND STATE/PROVINCIAL LAW RIGHTS

The warranty and remedies as set forth above are exclusive and in lieu of all others, oral or written, express or implied. To the extent permitted by applicable law, any implied warranties, including implied warranties of merchantability and fitness for a particular purpose, are hereby disclaimed. Some states/provinces do not allow limitations as to how long an implied warranty lasts or the exclusion or limitation of incidental or consequential damages, so the above limitations may not apply to you.

This warranty gives you specific legal rights, and you may have other rights, which vary from state/province to state/province. Neither CYBEX nor the dealer selling this product has authorized any person to create for it any other warranty, obligation, or liability in connection with this product.